

## CHEMICALS AND PUMP ADJUSTMENT

Dishwashers require the use of a detergent and possibly a rinse additive. The detergent must be of commercial strength to work in the unit's short cycle. The rinse additive will help the water to sheet on the glasses and plates, acting as a drying agent.

The products are a Sodium Hydroxide for the detergent and a surfactant isopropanol for the rinse. Quantities will vary with water quality but as a guideline there should be 200 ppm for the detergent and 50 ppm for the rinse-agent. Those products are available from any chemical company. Never use chlorinated product such as sanitizer and bleach. These products can damage the equipment.

Should you run out of these products, you can use residential brand product as a temporary measure. Do NOT use soap that produces suds. Use those product that are sold for dishwashers. Good quality chemical product will improve the washing.

Models 727, 737, F-16, F-16DP, F-18, F-18DP & F-20 are supplied with a factory installed liquid detergent pump to automatically dispense detergent into the wash tank chambers. Before accessing the bottom section of the dishwasher, make sure that the power was turned off at the source (breaker panel).

The bottom panel can only be remove with a flat tool like a screw-driver. Insert the screw-driver in the gap between the front panel and the side panel. Pry open towards you. Do this on both side.



The clear hoses connected to the pumps must be pulled out and fed through the bottom of the dishwasher. The containers can be either to the right or left of the dishwasher. Perforating the stainless panel is not recommended.

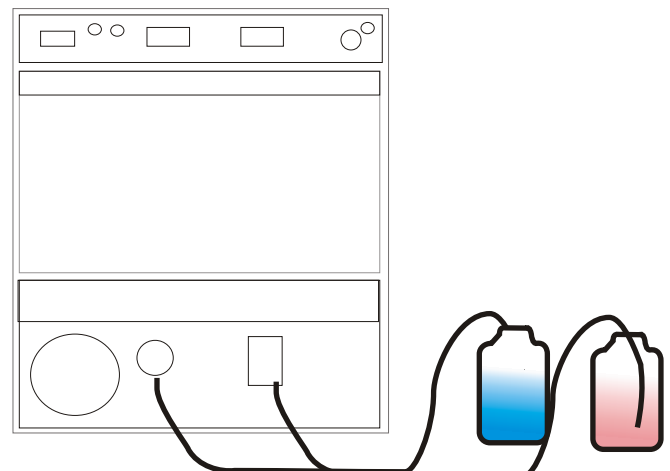
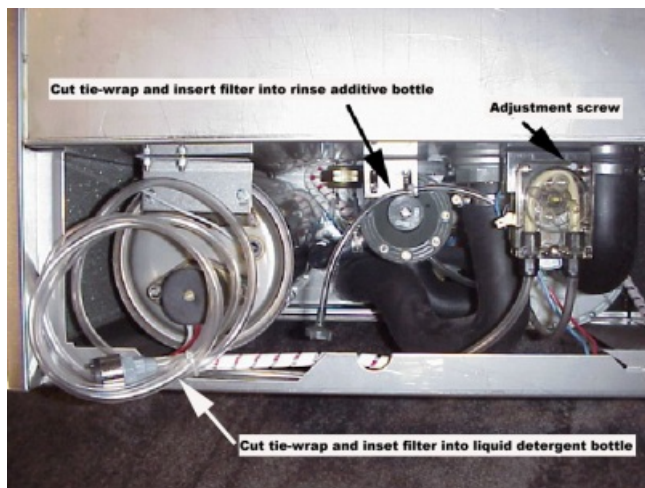

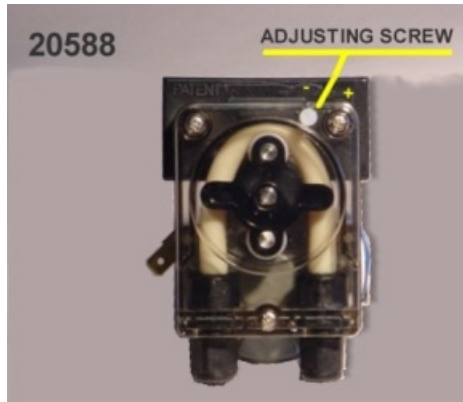

The quantity of liquid detergent can be increased (clockwise) or decreased (counter clockwise) by adjusting the screw on the peristaltic pump. The pump works during the fill cycle and rinse cycle.

(Identified above as "Adjustment screw")

Don't forget to put the panel back on when finished.

### RINSE PUMP ADJUSTMENT AND PRIMING

· The rinse pump is standard equipment on all **JET-TECH** machines and automatically injects rinse additive into the rinse water for the final rinse.



· The rinse pump is located in the base of the machine near the booster tank. The front, lower panel (below the door) snaps off to access the rinse pump. Cut the cable tie, route the tube out from the base of the machine and drop the clear vinyl hose and filter into your rinse additive container. (Some models are supplied with a rinse additive bottle that fits inside the base of the machine)



Adjustments should be made clockwise to reduce the amount of rinse additive and counter clockwise to increase the amount of rinse additive.

· If air gets in the rinse hose or if the pump stops drawing additive from the container, the pump may need to be primed.

To Prime (accelerate the injection of chemical) the pump, follow these steps;

1) Turn OFF the machine, pull the overflow, and drain the wash tank. The wash tank must be empty has priming is done during the fill cycle.

2) Get access to rinse-additive pump (see above instructions) Turn the adjusting screw on the rinse pump approximately 10 turns counter clockwise, allowing maximum travel for the piston. The screw may fall out but this is not a problem. Just remember how many turns you had made when the screw fell out.

3) Turn the machine ON and count to 5, then turn the machine OFF and count to 5, do this several times, until the liquid is drawn up the tube to the rinse pump. Because the pump works when the water solenoid

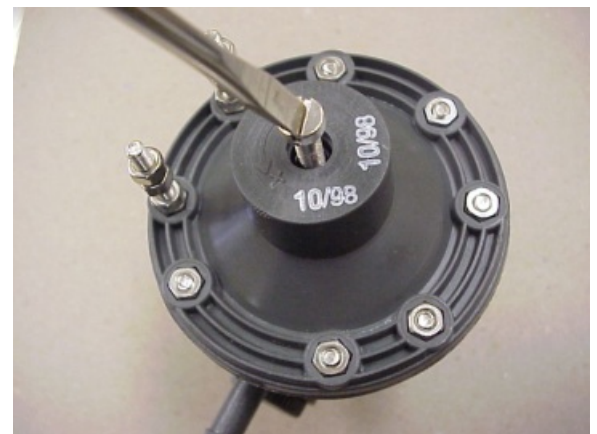

opens, causing the water pressure to push the internal piston, you should be able to see the liquid travel the length of the tube.

4) Once the liquid has reached the back of the pump, turn the adjusting screw on the rinse pump clockwise all the way in and counter-clockwise 3 full turns.

The rinse-aid pump can pump up to 3cc of rinse-additive (drying agent). The liquid is injected directly in to the booster tank.

**DO NOT** use sanitizer (chlorinated products, bleach) with this pump. It is not made to pump harsh chlorinated liquid. This will void warranty on the dishwasher.

#### Know Your Application.

When purchasing the detergent, it is important to specify what you want to wash. Most detergents sold on the market are good for regular soil (Non-greasy food on dishes and cups). Coffee and lipstick stains are usually very difficult to remove and pre-washing may be required. Greasy pans will involve a more specialized product. If an incorrect product is used, grease will accumulate inside the washing cabinet and cover everything.

For any other request on set-up and installation, please contact us at 1 888 275 4538 extension 611...

#### IMPORTANT

Remember to always use caution and protective gears whenever you are manipulating chemicals. They can burn the skin. Follow supplier's instructions carefully.



#### SPECIFICATIONS

Peristaltic pumps for dish-washing machines

Electronic regulation time-pause

G82

- max. delivery 0,6 l/h - silicone tube for rinse additive

- max. delivery 0,8 l/h - thermoplastic tube for detergent

G152

- max. delivery 1,5 l/h - thermoplastic tube for detergent

G202

- max. delivery 2,0 l/h - thermoplastic tube for detergent

G252

- max. delivery 2,3 l/h - thermoplastic tube for detergent

230V 50/60Hz (24V by request)

\* On request: Silicone tube

1 litre = 35.195 once

.55 ml/sec

# Components 20588

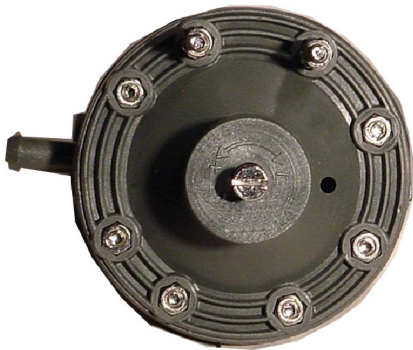
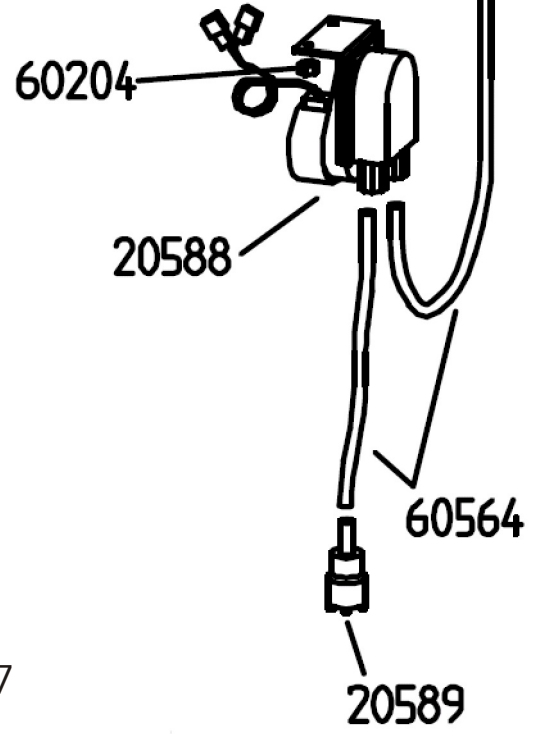
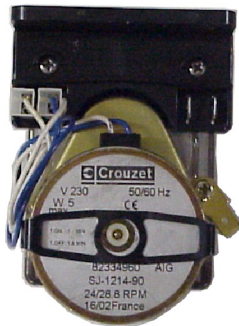
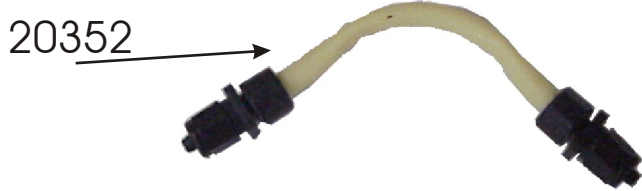
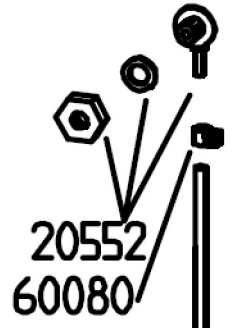

20199

