

F 16 DP

DAILY OPERATION PROCEDURES TO FOLLOW

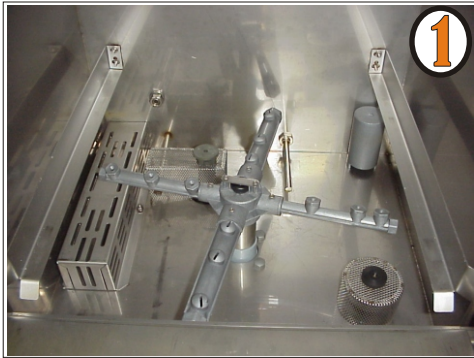

1 Make sure dishwasher is empty of water and the wash tank is clean of debris.

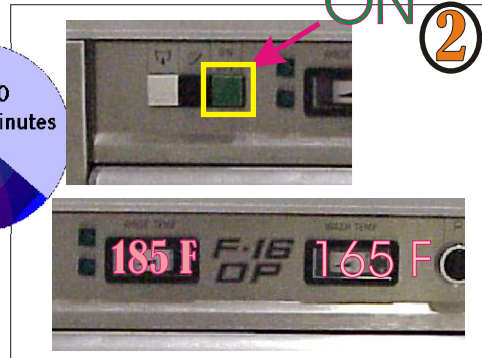
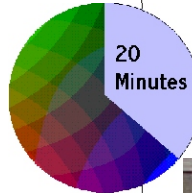

2 Close the door and press the power button. Wait 20 minutes for the water to attain optimum washing temperatures. This is done only once.

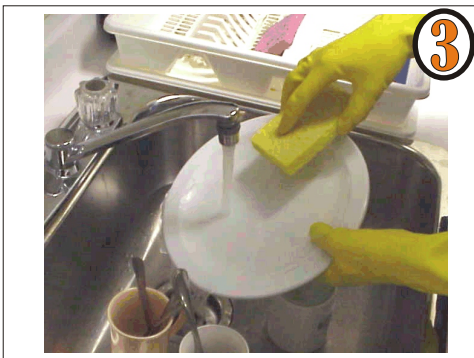

3 Pre-rinse dishes and/or glasses and cups.



4 Load rack in the dishwasher, close the door.



5 Press the Start button. Wash cycle is 3 minutes.



6 Wait for the green light to turn off before taking the tray out. Take tray out to let dishes air dry. Repeat from #3.

F 16

DAILY CLEANING PROCEDURES TO FOLLOW

This should be done at least once a day.

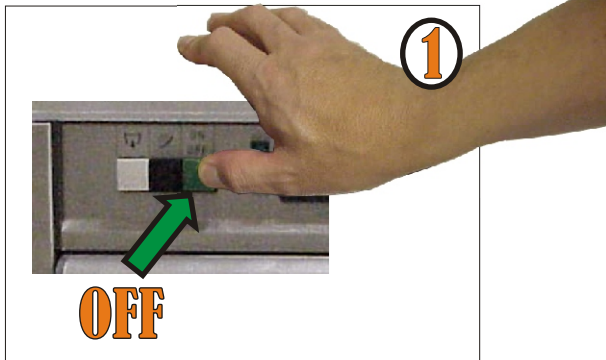

Push Power switch to OFF

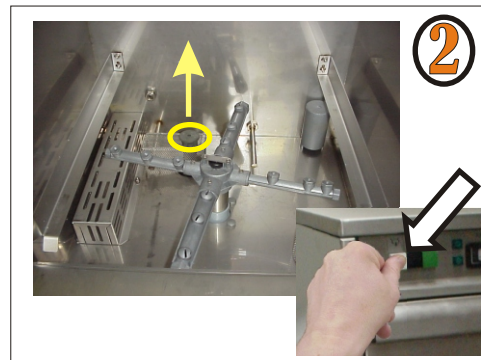

Push & Hold

- 1] Open the door.
- 2] Remove the Over-flow tube,
- 3] Drain unit. Push and hold white button.

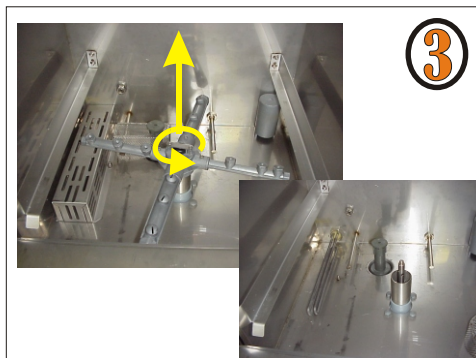

Let the water drain in the wash tank.
 Remove the spin-arm by unscrew the thumb-screw in the centre.
 Remove all the screens.
 Don't forget the top spin-arm.



Clean the screens and wash tank of debris.
 Rinse wash tank.
 Be careful not to push food debris down the drain.

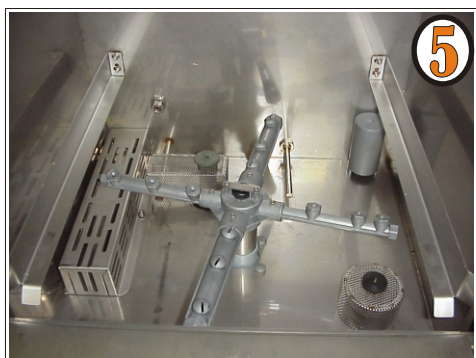

Put all parts back in the wash tank.
 Leave the dishwasher empty overnight,
 and leave it OFF.



OR refill for more usage by closing the door and pressing the green button.