

PRO333 MODEL STYLES

PRO333 models PRO333-0 to PRO333-5, PRO333-7, and PRO333-8 are constructed in the Deluxe disposer style.

Model PRO333-6 is constructed in the Badger disposer style with a bolted discharge.

Models PRO333-9 and above (PRO 333-10, PRO333-11, etc.) are constructed in the Badger disposer style with a threaded discharge.

REPLACING TRIM SHELL ASSEMBLY**DANGER**

Turn off electrical supply and disconnect disposer from plumbing/electrical before servicing.

MODELS PRO333-0 THROUGH PRO333-5, PRO333-7, AND PRO333-8

1. Remove clip from trim shell. Spread trim shell and lift up to remove.
2. Place new trim shell on disposer, aligning hole with waste outlet. Secure with clip.

MODEL PRO333-6 & PRO333-9 (AND ABOVE)

1. Unfasten two trim shell fasteners.
2. Remove trim cover from top.
3. Pull trim shell apart and remove it.
4. Remove sound insulation.
5. Place sound insulation on disposer.
6. Spread trim shell and place it on disposer. Close shell and snap trim shell fasteners.
7. Snap trim cover on top of trim shell.

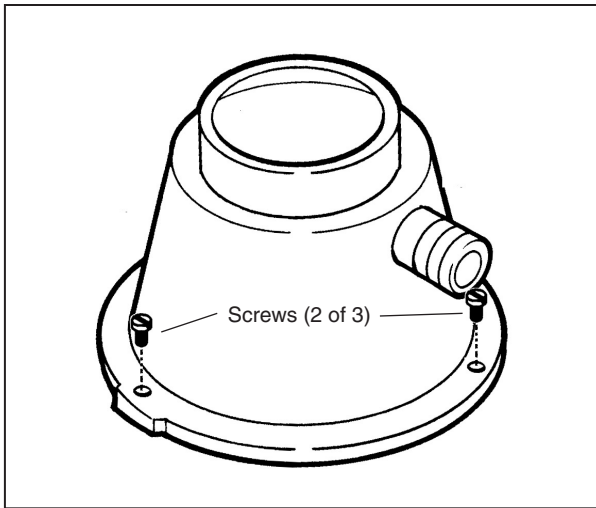

Figure 4.1

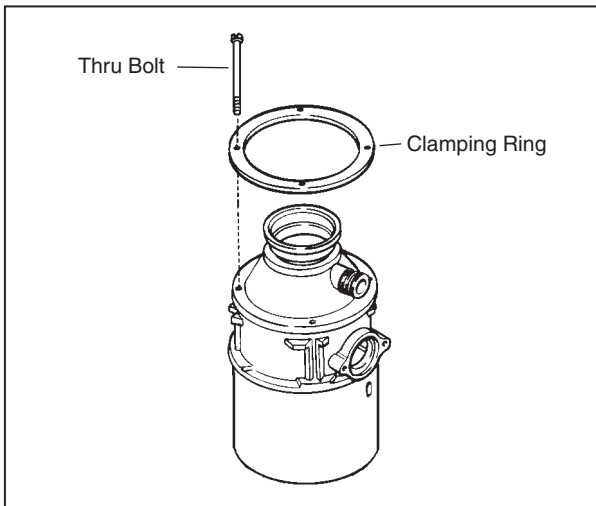

Figure 4.2

REPLACING BODY CONTAINER (& O-RING)

⚠ DANGER Turn off electrical supply and disconnect disposer from plumbing/electrical before servicing.

MODELS PRO333-0 THROUGH PRO333-5, PRO333-7, AND PRO333-8

1. Remove clip from trim shell. Spread trim shell and lift up to remove.
2. Remove three screws securing body container to upper end bell (see Figure 4.1). Separate body container from upper end bell. (If replacing faulty o-ring only, replace o-ring at this time.)
3. Place body container on upper end bell. Align three screw holes and secure with screws.
4. Place sound insulation, then trim shell on disposer, aligning trim shell hole with waste outlet. Snap clip onto trim shell.
5. If attaching dishwasher drain to disposer, ensure knockout plug is removed from new body container.

MODEL PRO333-6

1. Unfasten two trim shell fasteners.
2. Remove trim cover from top.
3. Pull trim shell apart and remove it.
4. Remove sound insulation.
5. Remove four thru bolts (thru bolts are secured with nuts or screwed directly into lower end frame). (See Figure 4.2.)
6. Lift body container off upper end bell.
7. Inspect o-ring for cuts, breaks, or worn areas and replace if necessary.
8. Place o-ring in groove on top of upper end bell/stationary shredder. Place new body container on top of upper end bell, aligning dishwasher inlet with waste outlet and thru bolt holes with guides, and ensuring o-ring remains seated.
9. Insert thru bolts and tighten.
10. If attaching dishwasher drain to disposer, ensure knockout plug is removed from new body container.
11. Place sound insulation, trim shell, and trim shell cover on disposer - fasten with trim shell fasteners.

PRO333-9 (AND ABOVE)

Threaded discharges are used on units with one piece enclosure assemblies, and are not servicable.

1. Replace entire unit.
2. If attaching dishwasher drain to disposer, ensure knockout plug is removed from new body container.

**REPLACING UPPER END BELL, ROTOR
SHAFT ASSEMBLY & ROTATING SHREDDER**

⚠ DANGER Turn off electrical supply and disconnect disposer from plumbing/electrical before servicing.

**MODELS PRO333-0 THROUGH PRO333-5, PRO333-7,
AND PRO333-8**

1. Remove clip from trim shell. Spread trim shell and lift up to remove.
2. Remove three screws securing body container to upper end bell (see Figure 4.3). Remove two thru bolts from bottom of disposer.
3. Place disposer on side and tap upper end bell gently with rawhide mallet to slightly separate from stator assembly, then insert flat blade screwdriver blade and twist to fully separate (see Figure 4.4).
4. Lift upper end bell/rotor shaft assembly straight up and off of stator. (Be careful not to damage stator windings.)
5. Turn upper end bell/rotor shaft assembly upside down. Check centrifugal switch for binding by applying thumb pressure to black ring (see Figure 4.5). If switch does not move up and down smoothly:
 - A. Remove two springs and actuating arms.
 - B. Remove phenolic ring by lifting up and turning.
 - C. Break off tabs securing switch and remove switch.
 - D. Install new centrifugal switch on rotor shaft by pushing assembly into position while rotating back and forth. (Switch will seat itself and move back and forth slightly in normal operation.)
6. Remove plastic plug from rotating shredder. Secure rotor shaft from turning with 1/4" allen wrench in end of rotor shaft or by jamming rotating shredder with screwdriver through discharge outlet (see Figure 4.6). Remove nut or bolt securing rotating shredder plate to rotor shaft and remove. Pull rotor shaft out from upper end bell.
7. Place upper end bell on rotor shaft assembly.
8. Install new sleeve and seal kit, following instructions included with kit.
9. Place rotating shredder plate on rotor shaft and secure with nut or bolt. Install plastic plug.
10. Place upper end bell on stator, align witness marks on upper end bell (opposite discharge outlet) and stator (opposite weld), and seat by tapping with rawhide or wooden mallet (be careful not to damage stator windings).
11. Tap upper end bell into stator with mallet until fully seated.
12. Place o-ring on body container and place body container on upper end bell. Align screw holes and secure with screws.
13. Place trim shell on disposer, aligning hole with waste outlet. Secure with clip.

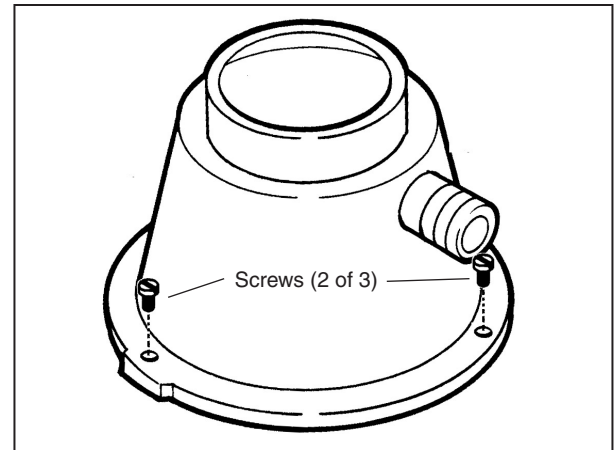

Figure 4.3

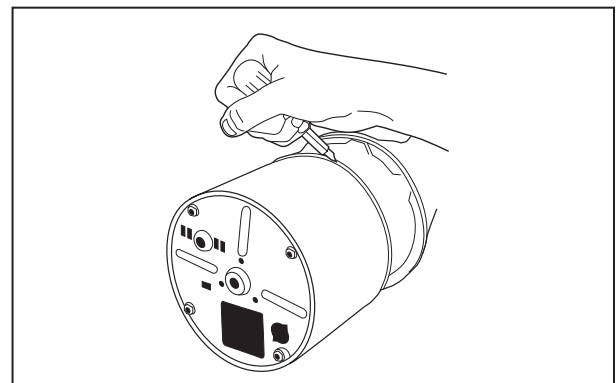

Figure 4.4

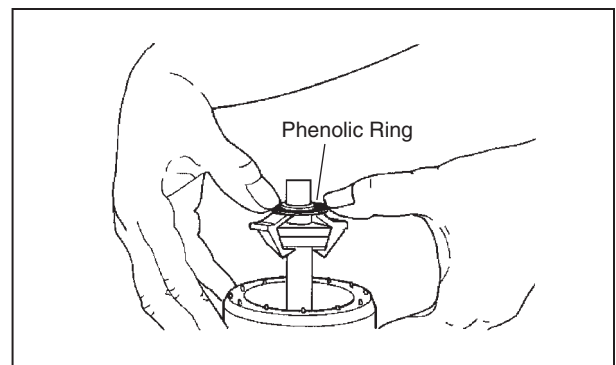

Figure 4.5

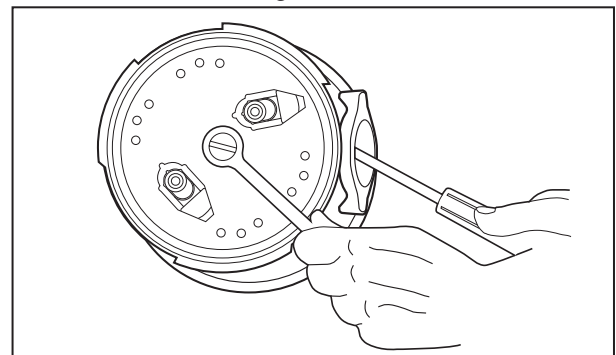

Figure 4.6

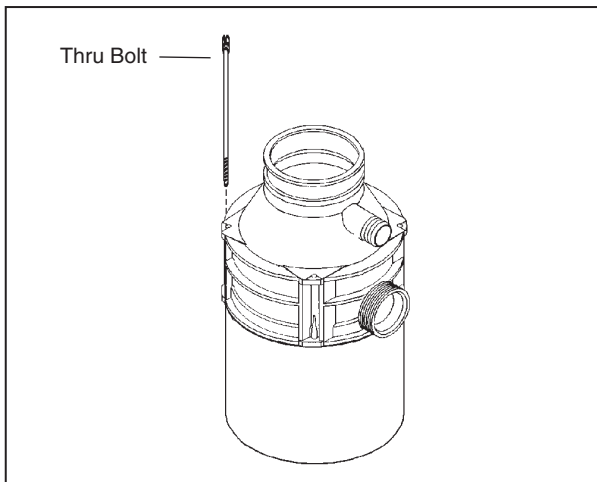

Figure 4.7

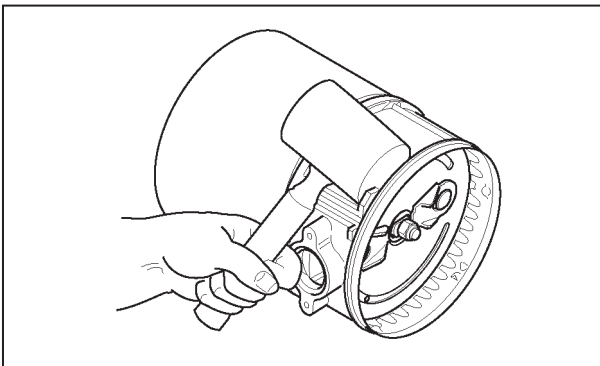

Figure 4.8

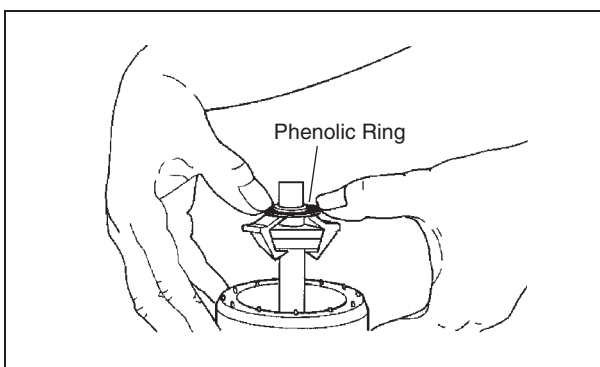

Figure 4.9

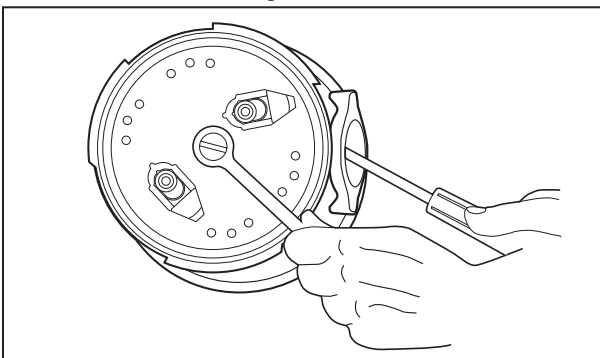

Figure 4.10

MODEL PRO333-6

1. Unfasten two trim shell fasteners.
2. Remove trim cover from top.
3. Pull trim shell apart and remove it.
4. Remove sound insulation.
5. Remove four thru bolts (thru bolts are secured with nuts or screwed directly into lower end frame). (See Figure 4.7.)
6. Lift body container off upper end bell.
7. Inspect o-ring for cuts, breaks, or worn areas and replace if necessary.
8. Place disposer on its side. Lightly tap upper end bell ridge with rawhide mallet until upper end bell begins to separate from stator (see Figure 4.8).
9. Place disposer "right side up." Insert flathead screwdriver between upper end bell and stator to separate.
10. Lift upper end bell/rotor shaft assembly straight up and off of stator. (Be careful not to damage stator windings.)
11. Turn upper end bell/rotor shaft assembly upside down. Check centrifugal switch for binding by applying thumb pressure to black ring (see Figure 4.9). If switch does not move up and down smoothly:
 - A. Remove two springs and actuating arms.
 - B. Remove phenolic ring by lifting up and turning.
 - C. Break off tabs securing switch to rotor shaft and remove switch.
 - D. Install new centrifugal switch on rotor shaft by pushing assembly into position while rotating back and forth. (Switch will seat itself and move back and forth slightly in normal operation.)
12. Secure rotor shaft from turning with 1/4" allen wrench in end of rotor shaft or by jamming rotating shredder with screwdriver through discharge outlet (see Figure 4.10). Remove bolt securing rotating shredder plate to rotor shaft. Pull rotor shaft out from upper end bell.
13. Locate three half-round protrusions on inside of stationary shredder (see Figure 4.11).
14. Hold rotating shredder lugs and pull shredder plate up and toward you so plate is above two of three protrusions (see Figure 4.12). Pull plate free from upper end bell. (There may be slight resistance due to interference fit.)
15. Remove slinger and sleeve from center of upper end bell. (Do not attempt to remove water seal unless it is damaged.)
16. Inspect rotating shredder, upper end bell, rotor shaft, and thrust washer for damage or wear. Replace parts if necessary.
17. Seat upper end bell on rotor shaft assembly so rotor shaft shoulder protrudes through upper end bell approximately 3/4" (see Figure 4.13).
18. Install new sleeve and seal kit according to instructions included in kit.

20. To install rotating shredder, lift upper end bell slightly so sleeve is almost flush with shoulder. Slide rotating shredder plate under two of three protrusions and push plate into place. (There may be slight resistance from interference fit.)
21. Thread and torque nut (or bolt) onto rotor shaft to 30-40 ft. lbs.
22. Place upper end bell on stator, align witness marks on upper end bell (opposite discharge outlet) and stator (opposite weld), and seat by tapping with rawhide or wooden mallet (be careful not to damage stator windings).
23. Place o-ring in groove on top of upper end bell/stationary shredder. Place new body container on top of upper end bell, aligning dishwasher inlet with waste outlet and thru bolt holes with guides, and ensuring o-ring remains seated.
24. Insert thru bolts and tighten.
25. Place sound insulation, trim shell, and trim shell cover on disposer - fasten with trim shell fasteners.

PRO333-9 (AND ABOVE)

Threaded discharges are used on units with one piece enclosure assemblies, and are not servicable.

1. Replace entire unit.
2. If attaching dishwasher drain to disposer, ensure knockout plug is removed from new body container

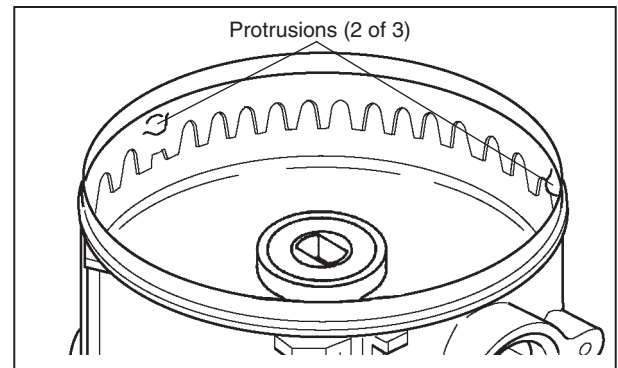

Figure 4.11

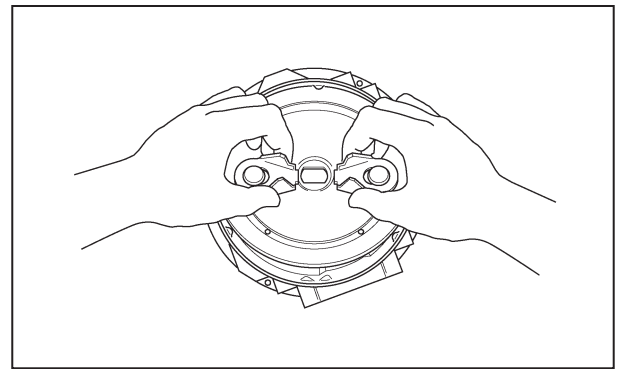

Figure 4.12

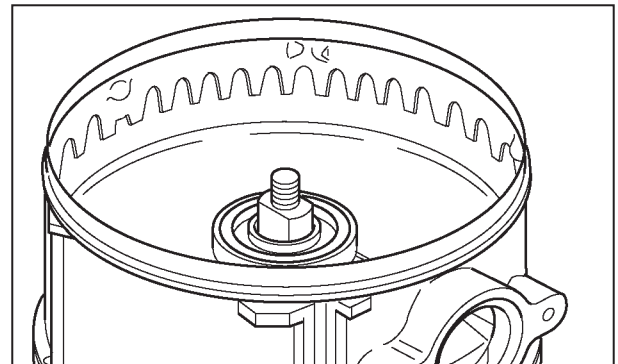

Figure 4.13

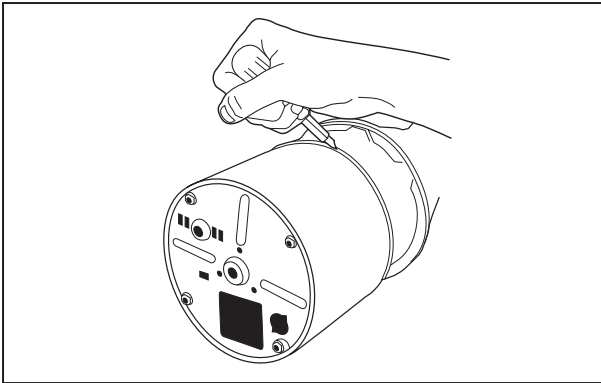

Figure 4.14

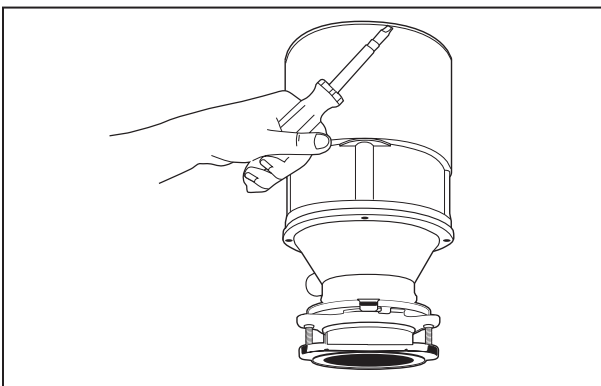

Figure 4.15

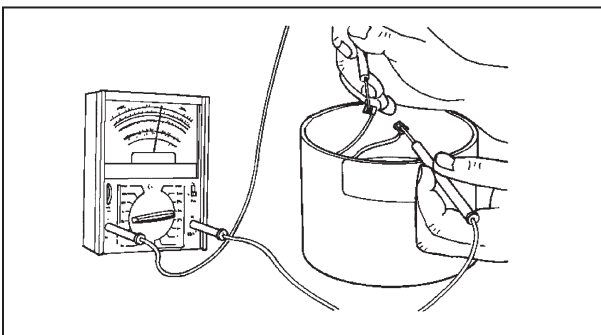

Figure 4.16

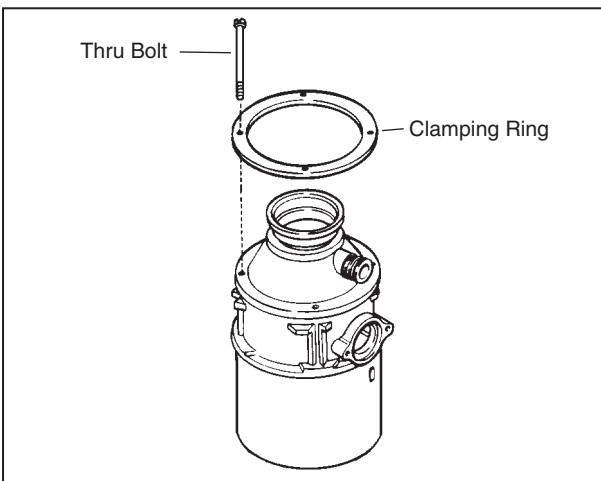

Figure 4.17

TESTING AND REPLACING STATOR

⚠ DANGER Turn off electrical supply and disconnect disposer from plumbing/electrical before servicing.

MODELS PRO333-0 THROUGH PRO333-5, PRO333-7 AND PRO333-8

1. Remove clip from trim shell. Spread trim shell and lift up to remove.
2. Remove thru bolts from bottom of disposer.
3. Place disposer on side and tap upper end bell gently with rawhide mallet to slightly separate from stator assembly, then insert flat blade screwdriver blade and twist to fully separate (see Figure 4.14). Gently lift upper end bell from stator assembly, being careful not to damage stator windings.
4. Place edge of flathead screwdriver between lower end frame and stator; tap end of screwdriver with rawhide mallet to separate lower end frame (see Figure 4.15).
5. Remove, three electrical wires from start switch and overload protector.
6. Test stator windings for open, grounded, or shorted conditions by connecting ohm meter leads to stator red and orange wires (see Figure 4.16). If meter does not move, replace stator.
7. Connect meter leads to orange stator wire and to metal stator body; repeat with red stator wire. In each test, if meter moves, replace stator.
8. Connect wires according to appropriate wiring diagram.
9. Align lower end frame witness marks with stator witness marks and seat lower end frame with rawhide mallet.
10. Place upper end bell on stator, align witness marks on upper end bell (opposite discharge outlet) and stator (opposite weld), and seat by tapping with rawhide or wooden mallet (be careful not to damage stator windings).
11. Tap upper end bell into stator with rawhide mallet until fully seated.
12. Place trim shell on disposer, aligning hole with waste outlet. Secure with clip.

MODEL PRO333-6

1. Unfasten two trim shell fasteners.
2. Remove trim cover from top.
3. Pull trim shell apart and remove it.
4. Remove sound insulation.
5. Remove four thru bolts (thru bolts are secured with nuts or screwed directly into lower end frame). (See Figure 4.17.)
6. Lift body container off upper end bell.
7. Inspect o-ring for cuts, breaks, or worn areas and replace if necessary.
8. Place disposer on its side. Lightly tap upper end bell ridge with rawhide mallet until upper end bell begins to separate from stator (see Figure 4.18).

9. Place disposer "right side up." Insert flathead screwdriver between upper end bell and stator to separate.
10. Lift upper end bell/rotor shaft assembly straight up and off of stator. (Be careful not to damage stator windings.)
11. Place edge of flathead screwdriver between lower end frame and stator; tap end of screwdriver with rawhide mallet to separate lower end frame (see Figure 4.19).
12. Remove electrical wires from start switch and overload protector.
13. Test stator windings for open, grounded, or shorted conditions by connecting ohm meter leads to stator red and orange wires (see Figure 4.20). If meter does not move, replace stator.
14. Connect meter leads to orange stator wire and to metal stator body; repeat with red stator wire. In each test, if meter moves, replace stator.
15. Connect wires according to appropriate wiring diagram.
16. Align lower end frame witness marks with stator witness marks and seat lower end frame with rawhide mallet.
17. Place upper end bell on stator, align witness marks on upper end bell (opposite discharge outlet) and stator (opposite weld), and seat by tapping with rawhide or wooden mallet (be careful not to damage stator windings).
18. Place o-ring in groove on top of upper end bell/stationary shredder. Place new body container on top of upper end bell, aligning dishwasher inlet with waste outlet and thru bolt holes with guides, and ensuring o-ring remains seated.
19. Insert thru bolts and tighten.
20. Place sound insulation, trim shell, and trim shell cover on disposer - fasten with trim shell fasteners.

PRO333-9 (AND ABOVE)

1. Unfasten two trim shell fasteners.
2. Remove trim cover from top.
3. Pull trim shell apart and remove it.
4. Remove sound insulation.
5. Remove four thru bolts (see Figure 4.21).
6. Place disposer on its side. Place screwdriver tip against enclosure assembly ridge and lightly tap upper with rawhide (see Figure 4.19).
7. Place disposer "right side up." Insert flathead screwdriver between enclosure assembly and stator to separate.
8. Lift enclosure assembly straight up off of stator. (Be careful not to damage stator windings.)
9. Place edge of flathead screwdriver between lower end frame and stator; tap end of screwdriver with rawhide mallet to separate lower end frame (see Figure 4.22).
10. Remove electrical wires from start switch and overload protector.

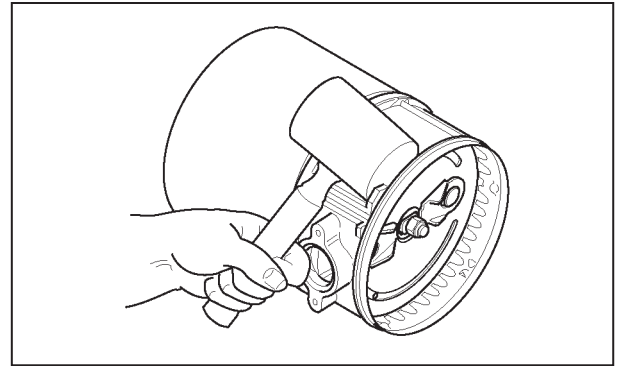

Figure 4.18

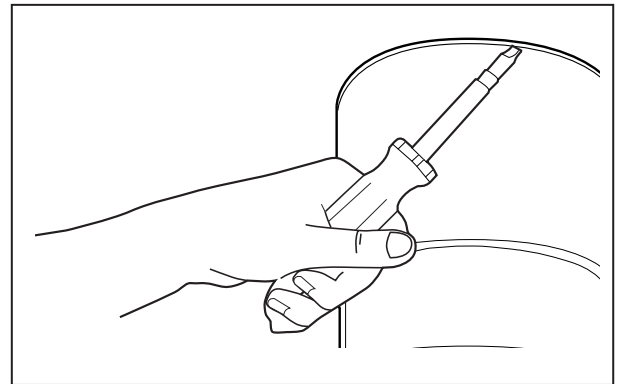

Figure 4.19

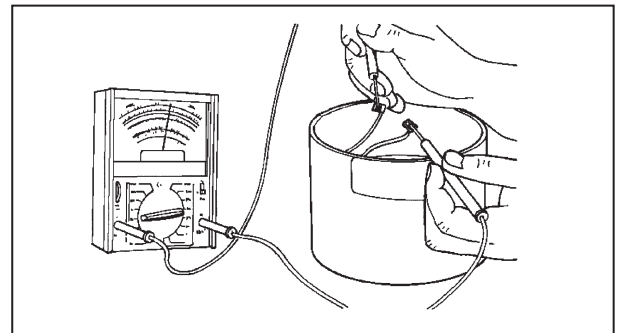

Figure 4.20

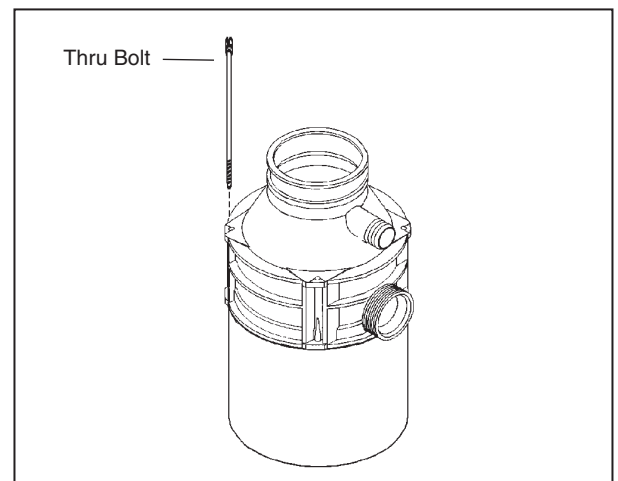

Figure 4.21

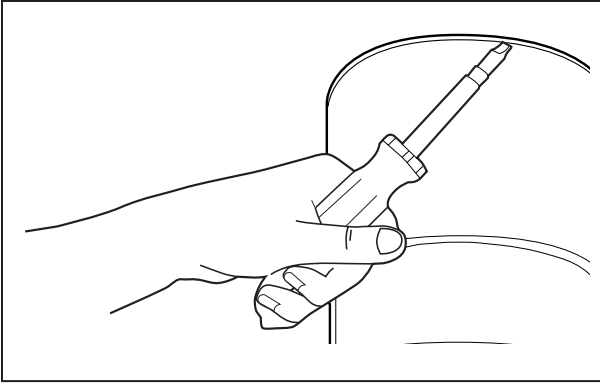

Figure 4.22

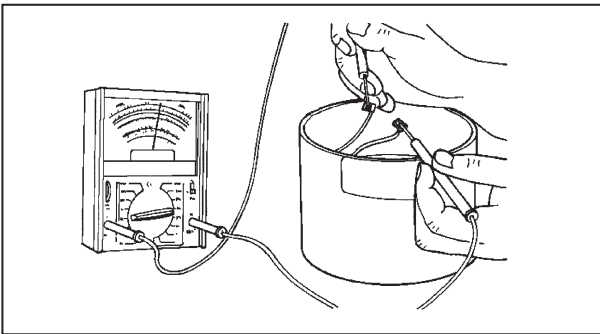

Figure 4.23

11. Test stator windings for open, grounded, or shorted conditions by connecting ohm meter leads to stator red and orange wires (see Figure 4.23). If meter does not move, replace stator.
12. Connect meter leads to orange stator wire and to metal stator body; repeat with red stator wire. In each test, if meter moves, replace stator.
13. Connect wires according to appropriate wiring diagram.
14. Align lower end frame witness marks with stator witness marks and seat lower end frame with rawhide mallet.
15. Place enclosure assembly on stator (aligning witness marks) and seat by tapping with rawhide or wooden mallet.
16. Tap upper end bell into stator with rawhide mallet until fully seated.
17. Insert thru bolts and tighten.
18. Place sound insulation, trim shell, and trim shell cover on disposer - fasten with trim shell fasteners.

**TESTING & REPLACING START SWITCH,
OVERLOAD PROTECTOR, & LOWER END
FRAME (ALL MODELS)**

⚠ DANGER Turn off electrical supply and disconnect disposer from plumbing/electrical before servicing.

1. Remove trim shell.
2. Remove thru bolts (thru bolts are secured with nuts or screwed directly into lower end frame).
3. Place edge of flathead screwdriver between lower end frame and stator; tap end of screwdriver with rawhide mallet to separate lower end frame (see Figure 4.24).
4. Remove black wire leading from stator to overload protector, orange wire from stator to start switch, and red wire from stator to start switch.
5. To test start switch with ohmmeter:
Remove wires leading to start switch. Place one meter probe on each terminal (see Figure 4.25) - if meter shows continuity, skip to Step 6. Keep probes on terminals and press down on actuator arm - if meter shows no continuity, skip to Step 6. If start switch tests O.K. skip to Step #7.
6. Replace start switch by squeezing start switch legs and pull start switch from lower end frame.
7. Test overload protector with ohmmeter (see Figure 4.26). Disconnect black stator lead wire and push in red button to engage overload protector and place ohmmeter probes on terminal and wire connector - there should be continuity (gauge needle moves). Replace overload protector if test shows no continuity.
8. Inspect lower end frame for damage. Replace if necessary.
9. Connect black stator lead wire to overload protector and place overload protector in start switch leg housing and install start switch.
10. Connect leads from stator to start switch (see appropriate wiring diagram).
11. Align witness marks on stator (opposite weld) and lower end frame (opposite electrical access hole), and place lower end frame on stator assembly. Lightly tap into place with rawhide or wooden mallet.
12. Place enclosure assembly on stator, align witness marks and seat by tapping with rawhide or wooden mallet.
13. Insert thru bolts and tighten.
14. Place sound insulation, trim shell, and trim shell cover on disposer - fasten with trim shell fasteners.

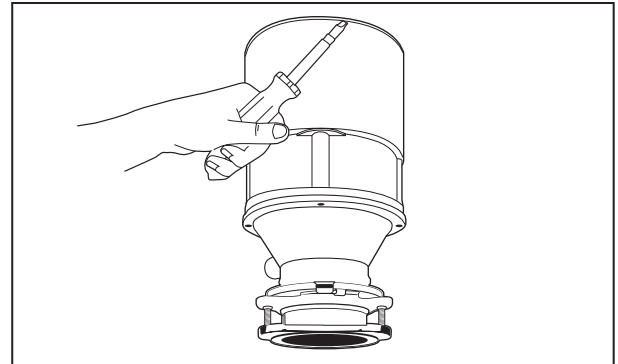

Figure 4.24

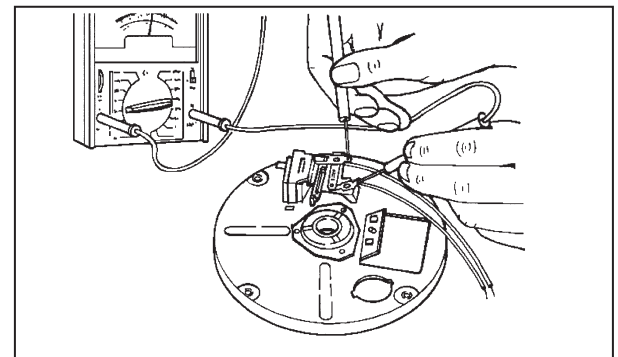

Figure 4.25

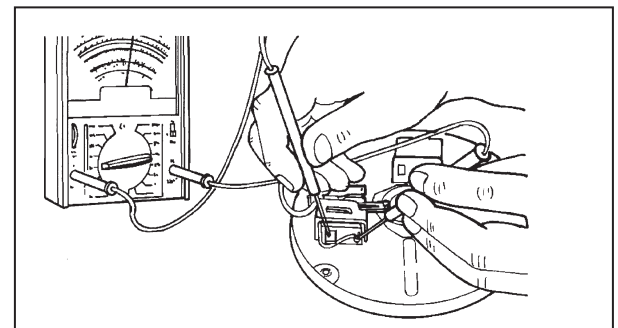

Figure 4.26