



TOAST-QWIK®

Electric Conveyor Toasters

TQ-700 Series

TQ-700

TQ-700H

TQ-700BA

TQ-700HBA

TQ-700-ENG

TQ-700H-S

REPLACEMENT PARTS LIST

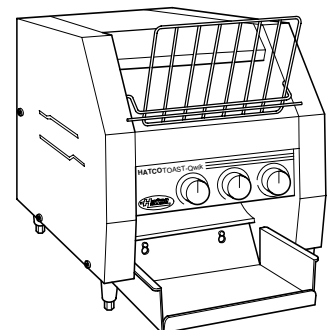

HATCO TOAST-QWIK® TQ-700 Series CONVEYOR TOASTERS

Model Designation

TQ-XXX,XXX

T	= Toast
Q	= Qwik
X	= Maximum slices per hour
BA	= Bagel
ENG	= England
H	= High Opening
HBA	= High Opening Bagel
H-S	= High Speed

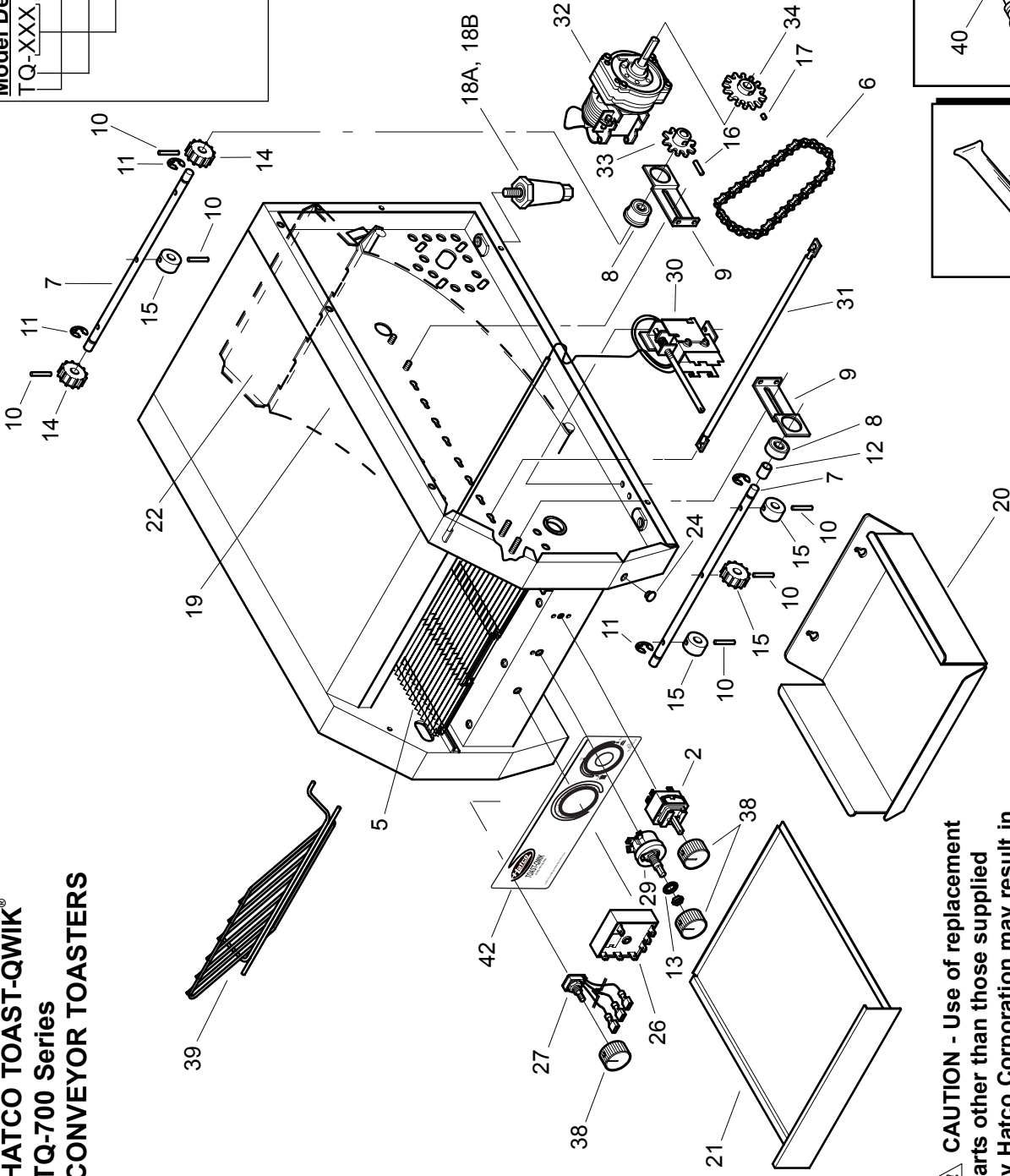

CAUTION - Use of replacement parts other than those supplied by Hatco Corporation may result in damage to the unit or injury to personnel.

PARTS COMMON TO ALL TQ-700, -700BA, -700-ENG, -700H, -700HBA, -700H-S MODELS

ITEM	DESCRIPTION	PART NO.	QTY.	ITEM	DESCRIPTION	PART NO.	QTY.
1	Diode	02.40.002.00	1	14	Sprocket-Conveyor	05.09.041.00	3
2	Selector Switch	R02.19.082.00	1	15	Sprocket-Idler	05.09.042.00	3
3	Cooling Fan Guard	02.12.011.00	1	16	Spring Pin 1/8" x 3/4"	05.08.006.00	1
4	Terminal Block (4 Pole)	02.15.047.00	1	17	Hollow Lock Screw	05.04.044.00	1
5	Conveyor Belt	05.03.024.00	1	18A	Leg 2-1/2" (6 cm) Clearance	05.30.040.00	4
6	Drive Chain	05.03.003.00	1	18B	Leg 4" (10 cm) Clearance	05.30.007.00	4
7	Shaft (Front & Rear)	05.07.011.00	2	19	Toast Ramp	04.05.235.00	1
8	Bearing	05.02.011.00	4	20	Toast Collector Pan	04.05.238.00	1
9	Bearing Support	04.05.207.00	4	21	Crumb Tray	04.05.234.00	1
10	Groove Pin 1/8" x 1"	05.03.023.00	6	22	Discharge Vane	04.05.215.00	1
11	Retaining Clip	05.11.035.00	4	23	Cord Grip	02.20.259.00	1
12	Bearing Spacer	05.11.022.00	2	24	Snap Plug 3/8" Black	02.20.217.00	1
13	Washer	05.11.002.00	1	25	Motor Bearing Lube	05.01.018.00	1

PARTS SPECIFIC TO MODEL TQ-700

ITEM	DESCRIPTION	120V 60 Hz	200V 50/60 Hz	208V 60 Hz	220V 60 Hz	240V 60 Hz	220V 50 Hz	240V 50 Hz	220-230V CE 50 Hz	230-240V CE 50 Hz
26	Solid State Infinite Heat Control	---	---	---	---	---	---	---	---	---
27	Potentiometer with Leads	---	---	---	---	---	---	---	---	---
28A	Relay	---	---	---	---	---	---	---	---	---
28B	Relay	---	---	---	---	---	---	---	---	---
28C	Relay	---	---	---	---	---	---	---	---	---
29	Rheostat	R02.13.101.00	R02.13.111.00	R02.13.111.00	R02.13.111.00	R02.13.111.00	R02.13.125.00	R02.13.125.00	R02.13.125.00	R02.13.125.00
30	Thermostat	02.16.011.00	02.16.011.00	02.16.011.00	02.16.011.00	02.16.011.00	02.16.011.00	02.16.011.00	02.16.011.00	02.16.011.00
31	Elements ■									
	200W (Quantity: 10)	R02.09.030.00	R02.09.037.00	R02.09.037.00	R02.09.038.00	R02.09.039.00	R02.09.038.00	R02.09.038.00	R02.09.203E.00	R02.09.214E.00
	325W (Quantity: 2)	R02.09.031.00	R02.09.040.00	R02.09.040.00	R02.09.041.00	R02.09.042.00	R02.09.041.00	R02.09.041.00	R02.09.206E.00	R02.09.217E.00
32	Gearmotor	R02.12.024.00	R02.12.020.00	R02.12.020.00	R02.12.021.00	R02.12.021.00	R02.12.025.00	R02.12.025.00	R02.12.025.00	R02.12.025.00
33	Driven Sprocket 10 Tooth	05.09.020.00	05.09.020.00	05.09.020.00	05.09.020.00	05.09.020.00	05.09.020.00	05.09.020.00	05.09.020.00	05.09.020.00
34	Drive Sprocket 14 Tooth	05.09.025.00	05.09.025.00	05.09.025.00	05.09.025.00	05.09.025.00	05.09.025.00	05.09.025.00	05.09.025.00	05.09.025.00
35	Cooling Fan	02.12.008A.00	02.12.010.00	02.12.010.00	02.12.010.00	02.12.010.00	02.12.010.00	02.12.010.00	02.12.010.00	02.12.010.00
36	Fuse, 1 Amp (2 Pack)	R02.03.005A.02	---	---	---	---	---	---	---	---
37	Fuse Holder with Fuse	R02.19.028.00	---	---	---	---	---	---	---	---
38	Knob (Quantity: 2)	05.30.020.00	05.30.020.00	05.30.020.00	05.30.020.00	05.30.020.00	05.30.020.00	05.30.020.00	05.30.020.00	05.30.020.00
39	Conveyor Feeder Guide	04.05.073.00	04.05.073.00	04.05.073.00	04.05.073.00	04.05.073.00	04.05.073.00	04.05.073.00	04.05.073.00	04.05.073.00
40	Power Cord	02.18.039.00	02.18.036.00	02.18.036.00	02.18.038.00	02.18.036.00	02.18.038.00	02.18.038.00	02.18.038.00	02.18.068.00
41	T-Block, 3 Pole, Snap In*	---	---	---	---	---	---	---	02.15.028.00	02.15.028.00
42	Decal, Control Panel	07.01.109.00	07.01.109.00	07.01.109.00	07.01.109.00	07.01.109.00	07.01.109.00	07.01.109.00	07.01.109.00	07.01.109.00
	Electrical Drawing	HS1-2963	HS1-3221	HS1-2964	HS1-3236	HS1-2965	HS1-3015	HS1-3016	HS1-4073	HS1-4103

Shaded area reflects export models only.

■ Element configuration shown on back page.

* Not shown

PARTS SPECIFIC TO MODEL TQ-700BA

ITEM	DESCRIPTION	120V 60 Hz	200V 50/60 Hz	208V 60 Hz	220V 60 Hz	240V 60 Hz	220V 50 Hz	240V 50 Hz	220-230V CE 50 Hz	230-240V CE 50 Hz
26	Solid State Infinite Heat Control	---	---	---	---	---	---	---	---	---
27	Potentiometer with Leads	---	---	---	---	---	---	---	---	---
28A	Relay	---	---	---	---	---	---	---	---	---
28B	Relay	---	---	---	---	---	---	---	---	---
28C	Relay	---	---	---	---	---	---	---	---	---
29	Rheostat	R02.13.101.00	R02.13.111.00	R02.13.111.00	R02.13.111.00	R02.13.111.00	R02.13.125.00	R02.13.125.00		
30	Thermostat	02.16.011.00	02.16.011.00	02.16.011.00	02.16.011.00	02.16.011.00	02.16.011.00	02.16.011.00		
31	Elements ■									
	200W (Quantity: 1)	R02.09.030.00	R02.09.037.00	R02.09.037.00	R02.09.038.00	R02.09.039.00	R02.09.038.00	R02.09.039.00		
	325W (Quantity: 7)	R02.09.031.00	R02.09.040.00	R02.09.040.00	R02.09.041.00	R02.09.042.00	R02.09.041.00	R02.09.042.00		
32	Gearmotor	R02.12.024.00	R02.12.020.00	R02.12.020.00	R02.12.021.00	R02.12.021.00	R02.12.025.00	R02.12.025.00		
33	Driven Sprocket 10 Tooth	05.09.020.00	05.09.020.00	05.09.020.00	05.09.020.00	05.09.020.00	05.09.020.00	05.09.020.00		
34	Drive Sprocket 14 Tooth	05.09.025.00	05.09.025.00	05.09.025.00	05.09.025.00	05.09.025.00	05.09.025.00	05.09.025.00		
35	Cooling Fan	02.12.008A.00	02.12.010.00	02.12.010.00	02.12.010.00	02.12.010.00	02.12.010.00	02.12.010.00		
36	Fuse, 1 Amp (2 Pack)	R02.03.005A.02	---	---	---	---	---	---		
37	Fuse Holder with Fuse	R02.19.028.00	---	---	---	---	---	---		
38	Knob (Quantity: 2)	05.30.020.00	05.30.020.00	05.30.020.00	05.30.020.00	05.30.020.00	05.30.020.00	05.30.020.00		
39	Conveyor Feeder Guide	04.05.073.00	04.05.073.00	04.05.073.00	04.05.073.00	04.05.073.00	04.05.073.00	04.05.073.00		
40	Power Cord	02.18.039.00	02.18.036.00	02.18.036.00	02.18.038.00	02.18.036.00	02.18.038.00	02.18.038.00		
41	T-Block, 3 Pole, Snap In*	---	---	---	---	---	---	---		
42	Decal, Control Panel Electrical Drawing	07.01.204.00 HS1-3690	07.01.204.00 HS1-3695	07.01.204.00 HS1-3691	07.01.204.00 HS1-3696	07.01.204.00 HS1-3692	07.01.204.00 HS1-3693	07.01.204.00 HS1-3694		

Shaded area reflects export models only.

■ Element configuration shown on back page.

* Not shown

PARTS SPECIFIC TO MODEL TQ-700-ENG

ITEM	DESCRIPTION	120V 60 Hz	200V 50/60 Hz	208V 60 Hz	220V 60 Hz	240V 60 Hz	220V 50 Hz	240V 50 Hz	220-230V CE 50 Hz	230-240V CE 50 Hz
26	Solid State Infinite	---	---	---	---	---	---	---	---	---
	Heat Control	---	---	---	---	---	---	---	---	---
27	Potentiometer with Leads	---	---	---	---	---	---	---	---	---
28A	Relay	---	---	---	---	---	---	---	---	---
28B	Relay	---	---	---	---	---	---	---	---	---
28C	Relay	---	---	---	---	---	---	---	---	---
29	Rheostat	---	---	---	---	---	---	R02.13.125.00	---	---
30	Thermostat	---	---	---	---	---	---	02.16.011.00	---	---
31	Elements ■	---	---	---	---	---	---	R02.09.039.00	---	---
	200W (Quantity: 6)	---	---	---	---	---	---	R02.09.042.00	---	---
	325W (Quantity: 9)	---	---	---	---	---	---	R02.12.025.00	---	---
32	Gearmotor	---	---	---	---	---	---	05.09.020.00	---	---
33	Driven Sprocket 10 Tooth	---	---	---	---	---	---	05.09.025.00	---	---
34	Drive Sprocket 14 Tooth	---	---	---	---	---	---	02.12.010.00	---	---
35	Cooling Fan	---	---	---	---	---	---	---	---	---
36	Fuse, 1 Amp (2 Pack)	---	---	---	---	---	---	---	---	---
37	Fuse Holder with Fuse	---	---	---	---	---	---	---	---	---
38	Knob (Quantity: 2)	---	---	---	---	---	---	05.30.020.00	---	---
39	Conveyor Feeder Guide	---	---	---	---	---	---	04.05.073.00	---	---
40	Power Cord	---	---	---	---	---	---	02.18.103.00	---	---
41	T-Block, 3 Pole, Snap In*	---	---	---	---	---	---	---	07.01.109.00	---
42	Decal, Control Panel	---	---	---	---	---	---	HS1-3219	---	---
	Electrical Drawing	---	---	---	---	---	---	---	---	---

■ Shaded area reflects export models only.

■ Element configuration shown on back page.

* Not shown

PARTS SPECIFIC TO MODEL TQ-700H

ITEM	DESCRIPTION	120V 60 Hz	200V 50/60 Hz	208V 60 Hz	220V 60 Hz	240V 60 Hz	220V 50 Hz	240V 50 Hz	220-230V CE 50 Hz	230-240V CE 50 Hz
26	Solid State Infinite Heat Control	---	02.01.102.00	02.01.102.00	02.01.102.00	02.01.102.00	02.01.102.00	02.01.102.00	02.01.102.00	02.01.102.00
27	Potentiometer with Leads	---	02.01.113.00	02.01.113.00	02.01.113.00	02.01.113.00	02.01.113.00	02.01.113.00	02.01.113.00	02.01.113.00
28A	Relay†	---	R00.02.0018.00	R00.02.0018.00	R00.02.0020.00	R00.02.0019.00	R00.02.0020.00	R00.02.0019.00	---	---
28B	Relay◆	---	02.01.188.00	02.01.188.00	02.01.180.00	02.01.105.00	02.01.180.00	02.01.105.00	02.01.180.00	02.01.105.00
28C	Relay	---	---	---	---	---	---	---	---	---
29	Rheostat	---	R02.13.111.00	R02.13.111.00	R02.13.111.00	R02.13.111.00	R02.125.00.00	R02.13.125.00	R02.13.125.00	R02.13.125.00
30	Thermostat	---	02.16.011.00	02.16.011.00	02.16.011.00	02.16.011.00	02.16.011.00	02.16.011.00	02.16.011.00	02.16.011.00
31	Elements■	---	---	---	---	---	---	---	---	---
	200W (Quantity: 4)	---	R02.09.037.00	R02.09.037.00	R02.09.038.00	R02.09.039.00	R02.09.038.00	R02.09.039.00	R02.09.203E.00	R02.09.214E.00
	325W (Quantity: 9)	---	R02.09.040.00	R02.09.040.00	R02.09.041.00	R02.09.042.00	R02.09.041.00	R02.09.042.00	R02.09.206E.00	R02.09.217E.00
32	Gearmotor	---	R02.12.020.00	R02.12.020.00	R02.12.021.00	R02.12.021.00	R02.12.025.00	R02.12.025.00	R02.12.025.00	R02.12.025.00
33	Driven Sprocket 10 Tooth	---	05.09.020.00	05.09.020.00	05.09.020.00	05.09.020.00	05.09.020.00	05.09.020.00	05.09.020.00	05.09.020.00
34	Drive Sprocket 14 Tooth	---	05.09.025.00	05.09.025.00	05.09.025.00	05.09.025.00	05.09.025.00	05.09.025.00	05.09.025.00	05.09.025.00
35	Cooling Fan	---	02.12.010.00	02.12.010.00	02.12.010.00	02.12.010.00	02.12.010.00	02.12.010.00	02.12.010.00	02.12.010.00
36	Fuse, 1 Amp (2 Pack)	---	---	---	---	---	---	---	---	---
37	Fuse Holder with Fuse	---	---	---	---	---	---	---	---	---
38	Knob (Quantity: 3)	---	05.30.020.00	05.30.020.00	05.30.020.00	05.30.020.00	05.30.020.00	05.30.020.00	05.30.020.00	05.30.020.00
39	Conveyor Feeder Guide	---	04.05.252.00	04.05.252.00	04.05.252.00	04.05.252.00	04.05.252.00	04.05.252.00	04.05.252.00	04.05.252.00
40	Power Cord	---	02.18.111.00	02.18.111.00	02.18.103.00	02.18.111.00	02.18.103.00	02.18.103.00	02.18.103.00	02.18.103.00
41	T-Block, 3 Pole, Snap In*	---	---	---	---	---	---	---	02.15.028.00	02.15.028.00
42	Decal, Control Panel	---	07.01.201.00	07.01.201.00	07.01.201.00	07.01.201.00	07.01.201.00	07.01.201.00	07.01.201.00	07.01.201.00
	Electrical Drawing	---	HS1-3672	HS1-3634	HS1-3673	HS1-3635	HS1-3670	HS1-3671	HS1-4074	HS1-4109

Shaded area reflects export models only.

† Item 28A only used with toasters manufactured up to and including July 2000.

◆ Item 28B only used with toasters manufactured after July 2000.

NOTE: The last four digits in a ten digit numerical serial number is the date code.

Example: Serial number 9625060007 has a date code of "0007" which indicates the following; 00 07

00 Year 2000
07 Month Seven, July

Please also note, effective January 2001 the serial number date code was updated to indicate the week of manufacture. Example: xxxxxx01 24

01 Year 2001
24 Week Twenty-four

■ Element configuration shown on back page.

* Not shown

PARTS SPECIFIC TO MODEL TQ-700HBA

ITEM	DESCRIPTION	120V 60 Hz	200V 50/60 Hz	208V 60 Hz	220V 60 Hz	240V 60 Hz	220V 50 Hz	240V 50 Hz	220-230V CE 50 Hz	230-240V CE 50 Hz
26	Solid State Infinite Heat Control	---	---	02.01.102.00	02.01.102.00	02.01.102.00	02.01.102.00	02.01.102.00	---	---
27	Potentiometer with Leads	---	---	02.01.117.00	02.01.117.00	02.01.117.00	02.01.117.00	02.01.117.00	---	---
28A	Relay	---	---	---	---	---	---	---	---	---
28B	Relay	---	---	---	---	---	---	---	---	---
28C	Relay	---	---	02.01.098.00	02.01.098.00	02.01.098.00	02.01.098.00	02.01.098.00	---	---
29	Rheostat	---	---	R02.13.111.00	R02.13.111.00	R02.13.111.00	R02.13.125.00	R02.13.125.00	---	---
30	Thermostat	---	---	---	---	---	---	---	---	---
31	Elements ■	---	---	---	---	---	---	---	---	---
	200W (Quantity: 2)	---	---	R02.09.037.00	R02.09.038.00	R02.09.039.00	R02.09.038.00	R02.09.039.00	---	---
	375W (Quantity: 7)	---	---	R02.09.063.00	R02.09.064.00	R02.09.062.00	R02.09.064.00	R02.09.062.00	---	---
32	Gearmotor	---	---	R02.12.020.00	R02.12.021.00	R02.12.021.00	R02.12.025.00	R02.12.025.00	---	---
33	Driven Sprocket 10 Tooth	---	---	05.09.020.00	05.09.020.00	05.09.020.00	05.09.020.00	05.09.020.00	---	---
34	Drive Sprocket 14 Tooth	---	---	05.09.025.00	05.09.025.00	05.09.025.00	05.09.025.00	05.09.025.00	---	---
35	Cooling Fan	---	---	02.12.010.00	02.12.010.00	02.12.010.00	02.12.010.00	02.12.010.00	---	---
36	Fuse, 1 Amp (2 Pack)	---	---	---	---	---	---	---	---	---
37	Fuse Holder with Fuse	---	---	---	---	---	---	---	---	---
38	Knob (Quantity: 3)	---	---	05.30.020.00	05.30.020.00	05.30.020.00	05.30.020.00	05.30.020.00	---	---
39	Conveyor Feeder Guide	---	---	04.05.075.00	04.05.075.00	04.05.075.00	04.05.075.00	04.05.075.00	---	---
40	Power Cord	---	---	02.18.111.00	02.18.038.00	02.18.111.00	02.18.038.00	02.18.068.00	---	---
41	T-Block, 3 Pole, Snap In*	---	---	---	---	---	---	---	---	---
42	Decal, Control Panel Electrical Drawing	---	---	07.01.210.00	07.01.210.00	07.01.210.00	07.01.210.00	07.01.210.00	---	---
		---	---	HS1-3874	HS1-3913	HS1-3875	HS1-3912	HS1-3911	---	---

■ Shaded area reflects export models only.

■ Element configuration shown on back page.

* Not shown

PARTS SPECIFIC TO MODEL TQ-700H-S

ITEM	DESCRIPTION	120V 60 Hz	200V 50/60 Hz	208V 60 Hz	220V 60 Hz	240V 60 Hz	220V 50 Hz	240V 50 Hz	220-230V CE 50 Hz	230-240V CE 50 Hz
26	Solid State Infinite	---	---	---	---	---	---	---	---	---
27	Heat Control	---	---	---	---	---	---	---	---	---
27	Potentiometer with Leads	---	---	---	---	---	---	---	---	---
28A	Relay	---	---	---	---	---	---	---	---	---
28B	Relay	---	---	---	---	---	---	---	---	---
28C	Relay	---	---	---	---	---	---	---	---	---
29	Rheostat	---	---	R02.13.111.00	---	R02.13.111.00	---	---	---	---
30	Thermostat	---	---	---	---	---	---	---	---	---
31	Elements	---	---	---	---	---	---	---	---	---
	200W (Quantity: 4)	---	---	R02.09.037.00	---	R02.09.037.00	---	---	---	---
	325W (Quantity: 9)	---	---	R02.09.040.00	---	R02.09.042.00	---	---	---	---
32	Gearmotor	---	---	R02.12.020.00	---	R02.12.021.00	---	---	---	---
33	Driven Sprocket 17 Tooth	---	---	05.09.033.00	---	05.09.033.00	---	---	---	---
34	Drive Sprocket 7 Tooth	---	---	05.09.034.00	---	05.09.034.00	---	---	---	---
35	Cooling Fan	---	---	02.12.010.00	---	02.12.010.00	---	---	---	---
36	Fuse, 1 Amp (2 Pack)	---	---	R02.03.005A.02	---	---	---	---	---	---
37	Fuse Holder with Fuse	---	---	R02.19.028.00	---	---	---	---	---	---
38	Knob (Quantity: 3)	---	---	05.30.020.00	---	05.30.020.00	---	---	---	---
39	Conveyor Feeder Guide	---	---	04.05.252.00	---	04.05.252.00	---	---	---	---
40	Power Cord	---	---	02.18.122.00	---	02.18.111.00	---	---	---	---
41	T-Block, 3 Pole, Snap In*	---	---	---	---	---	---	---	---	---
42	Decal, Control Panel	---	---	07.01.109.00	---	07.01.109.00	---	---	---	---
	Electrical Drawing	---	---	HS1-4907	---	HS1-4908	---	---	---	---

Shaded area reflects export models only.

Element configuration shown on back page.

* Not shown

HATCO AUTHORIZED PARTS DISTRIBUTORS

ALABAMA

Jones McLeod Appl. Svc.
Birmingham 205-251-0159

ARIZONA

Auth. Comm. Food Equip.
Phoenix 602-234-2443
Byassee Equipment Co.
Phoenix 602-252-0402

CALIFORNIA

Industrial Electric
Huntington Beach 714-379-7100
Chapman Appl. Service
San Diego 619-298-7106
P & D Appliance
S. San Francisco 650-635-1900

COLORADO

Hawkins Commercial Appliance
Englewood 303-781-5548

DELAWARE

Food Equipment Service
Wilmington 302-996-9363

FLORIDA

Whaley Foodservice Repair
Jacksonville 904-725-7800
Nass Service Co., Inc.
Orlando 407-425-2681
B.G.S.I.
Pompano Beach 954-971-0456
Comm. Appliance Service
Tampa 813-663-0313

GEORGIA

Adcox Service Co.
Atlanta 404-361-8010
Southeastern Rest. Svc.
Norcross 770-446-6177

HAWAII

Burney's Comm. Service, Inc.
Honolulu 808-848-1466
Food Equip Parts & Service
Honolulu 808-847-4871

ILLINOIS

Parts Town
Lombard 708-865-7278
Eichenauer Elec. Service
Decatur 217-429-4229
Midwest Elec. Appl. Service
Elmhurst 630-279-8000
Cone's Repair Service
Moline 309-797-5323

INDIANA

GCS Service
Indianapolis 317-545-9655

IOWA

Electric Motor Service Co.
Davenport 319-323-1823

KENTUCKY

GCS Service
Louisville 502-367-1788

LOUISIANA

Chandlers Parts & Service
Baton Rouge 225-272-6620
Bana Comm. Parts, Inc.
Shreveport 318-631-6550

MARYLAND

Electric Motor Service
Baltimore 410-467-8080
GCS Service
Silver Spring 301-585-7550

MASSACHUSETTS

Ace Service Co., Inc.
Needham 781-449-4220

MICHIGAN

Commercial Kitchen Service
Bay City 517-893-4561
Bildons Appliance Service
Detroit 248-478-3320
Midwest Food Equip. Service
Grandville 616-261-2000

MINNESOTA

GCS Service
Minneapolis 612-546-4221

MISSOURI

GCS Service
Kansas City 816-920-5999
Commercial Kitchen Services
St. Louis 314-890-0700
Kaemmerlen Parts & Service
St. Louis 314-535-2222

NEBRASKA

Anderson Electric
Omaha 402-341-1414

NEVADA

Burney's Commercial
Las Vegas 702-736-0006
Hi. Tech Commercial Service
N. Las Vegas 702-649-4616

NEW JERSEY

Jay Hill Repair
Fairfield 973-575-9145
Service Plus
Flanders 973-691-6300

NEW YORK

Acme American Repairs, Inc.
Brooklyn 718-456-6544

NEW YORK (continued)

Alpro Service Co.
Brooklyn 718-386-2515
Appliance Installation
Buffalo 716-884-7425
Northern Parts Dist.
Plattsburgh 518-563-3200
J. B. Brady, Inc.
Syracuse 315-422-9271

NORTH CAROLINA

Authorized Appliance
Charlotte 704-377-4501

OHIO

Akron/Canton Comm. Svc. Inc.
Akron 330-753-6635
Certified Service Center
Cincinnati 513-772-6600
GCS Service
Columbus 614-476-3225
Electrical Appl. Repair Service
Independence 216-459-8700
E. A. Wichman Co.
Toledo 419-385-9121

OKLAHOMA

Hagar Rest. Service, Inc.
Oklahoma City 405-235-2184
Krueger, Inc.
Oklahoma City 405-528-8883

OREGON

Bressie Electric Co.
Portland 503-231-7171
Ron's Service, Inc.
Portland 503-624-0890

PENNSYLVANIA

FAST Comm. Appl. Service
Philadelphia 215-288-4800
GCS Service
Pittsburgh 412-787-1970
K & D Service Co.
Harrisburg 717-236-9039
Elmer Schultz Services
Philadelphia 215-627-5401
Electric Repair Co.
Reading 610-376-5444

RHODE ISLAND

Marshall Electric Co.
Providence 401-331-1163

SOUTH CAROLINA

Whaley Foodservice Repair
W. Columbia 803-791-4420

TENNESSEE

Camp Electric
Memphis 901-527-7543

TEXAS

Stove Parts Supply
Fort Worth 817-831-0381
Armstrong Repair Service
Houston 713-666-7100
Commercial Kitchen Repair Co.
San Antonio 210-735-2811
San Antonio Rest. Equip.
San Antonio 210-532-1660

UTAH

GCS Service
Salt Lake City 801-487-3653

VIRGINIA

Daubers
Norfolk 757-855-4097
Daubers
Springfield 703-866-3600

WASHINGTON

Restaurant Appl. Service
Seattle 206-524-8200

WISCONSIN

A.S.C., Inc.
Madison 608-246-3160
A.S.C., Inc.
Milwaukee 414-543-6460

CANADA

BRITISH COLUMBIA

Key Food Equipment Service
Vancouver 604-433-4484

ONTARIO

R.G. Henderson Ltd.
Toronto 416-422-5580
Choquette CKS
Ottawa 613-739-8458

QUÉBEC

Choquette CKS
Montreal 514-722-2000
Choquette CKS
Québec City 418-681-3944

HATCO CORPORATION

P.O. Box 340500, Milwaukee, WI 53234-0500 U.S.A.

(800) 558-0607 (414) 671-6350

Parts & Service Fax (800) 690-2966 Int'l. Fax (414) 671-3976

www.hatcocorp.com