



XOB

-212, -424, -636, -848
Open Burner Range

30 Pine Street • New Rochelle • New York • 10801

914 / 576 - 0200

914 / 576 - 0605 fax

1 - 800 - 431 - 2745 US & Canada

www.bakerspride.com web address

Models: XOB-212, -424, -636, -848

PARTS LIST & EXPLODED VIEW

Cookline
 SERIES

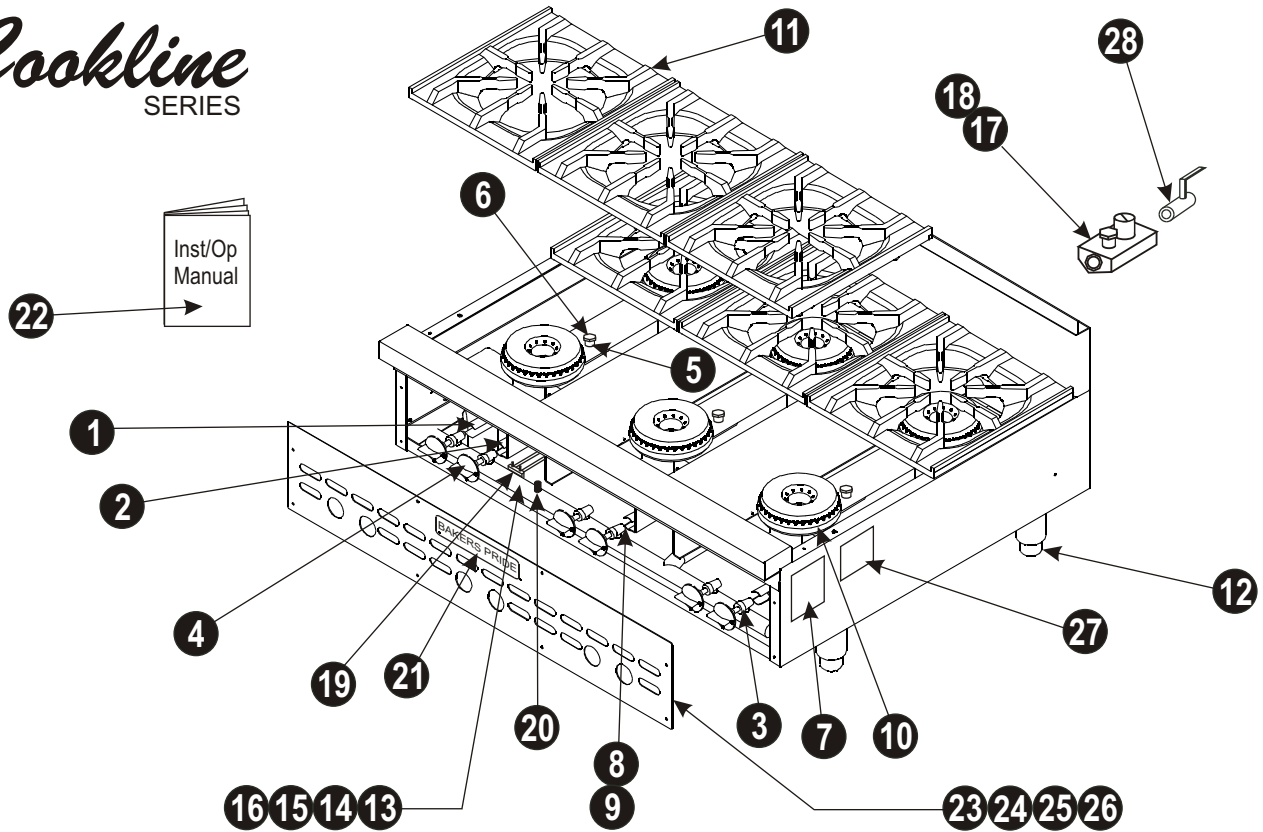

Item	Part Number	Description	Item	Part Number	Description
1	R3203A	Front Venturi	15	R1149A	Manifold 24"
2	R3204A	Rear Venturi	16	R1148A	Manifold 12"
3	R3032X	Gas Valve	17	M1008A	Pressure Reg, Nat 3.5" WC
4	S1094A	Knob	18	M1009A	Pressure Reg, LP 10" WC
5	N5803A	Aluminum Tubing 3/16"	19	R3020A	Pilot Valve, Dual
6	M1460A	Pilot Burner	20	N3023A	1/8 Plug, Brass
7	U1358A	Rating Plate	21	U1044X	BP Nameplate, 8"
8	R3205A	Orifice, Nat #38	22	U4192A	Inst/Op Manual
9	R3222P	Orifice, LP #52	23	G7018K	Front Panel, 12"
10	L5105A	Burner, Cast Iron	24	G7019K	Front Panel, 24"
11	T1247A	Grate 12" x 13", Cast Iron	25	G7020K	Front Panel, 36"
12	S1395A	Leg 6"	26	G7010K	Front Panel, 48"
13	R1151A	Manifold 48"	27	U1381A	Plate, Lighting Instructions
14	R1150A	Manifold 36"	28	R3206A	Valve, Gas Shut-Off

Model Number - Width		Serial Number	Type of Gas
XOB-212 <input type="checkbox"/> 12"	XOB-636 <input type="checkbox"/> 36"	_____	Natural <input type="checkbox"/>
XOB-424 <input type="checkbox"/> 24"	XOB-848 <input type="checkbox"/> 48"		L.P. <input type="checkbox"/> Other <input type="checkbox"/>