

Aladdin Temp-Rite®



P.O. Box 2978, Hendersonville, TN 37077-2978

1-800-888-8018 or 615-537-3600

Fax 1-888-812-9956 www.aladdintemprite.com

...better by degrees.

MODEL IHA-99S / IHA-99SAE HEAT ON DEMAND®² HEAT ACTIVATOR & BASE



INSTALLATION, OPERATION & SERVICE MANUAL

Manual P/N 93442
Rev. C 11/27/2006

HEAT ON DEMAND® U. S. Patent# 5,603,858 and 5,786,643 other U.S.
and Foreign Patents Pending

Please read this manual completely before attempting to operate, install or service this equipment! Failure to follow these instructions and precautions could cause death, injury or equipment damage!

After receiving, inspect all components immediately.
Notify carrier of damage! See page 6.

TECHNICAL BULLETIN

Condition: Overheated Bases

The Aladdin Heat on Demand Products are designed with a temperature measurement sensor located under the base guide. This sensor should be cleaned weekly due to possible debris accumulation during operation. If the sensor is not kept clean, the base may be damaged after the initial heating cycle by either accidental or intentional re-entering a previously heated base.

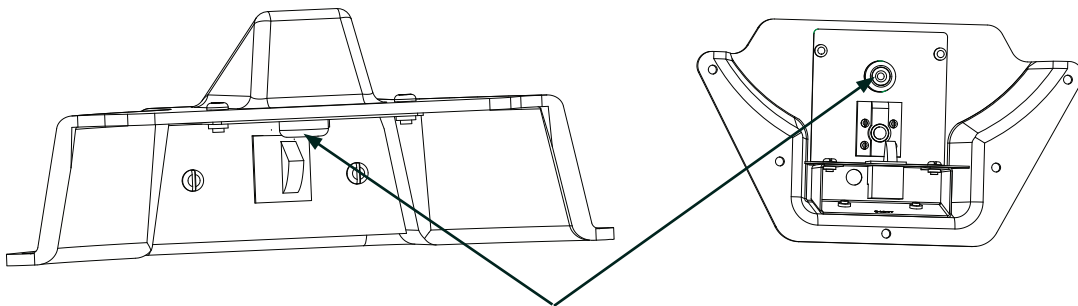

Clean sensor weekly by wetting a Q-tip with water and lightly swab the sensor.

Solution: Clean Sensor

To Clean:

- 1) Wet a Q-tip with water (soaps or glass cleaner will damage the sensor)
- 2) Swab the middle of the temperature measurement sensor

To verify the sensor is clean:

- 1) Place a clean dry base into the guide to be heated.
- 2) After the heating cycle has ended, Remove the base
- 3) Count 3 seconds.
- 4) Place the same base back into the guide and the green ready lamp should glow within 4 seconds or less. If not, the temperature detection system is not functioning properly contact the Aladdin Technical service department.

HEAT ON DEMAND[®]2 ACTIVATOR

CONTENTS

I.	INTRODUCTION	4
II.	SAFETY	4
III.	SPECIFICATIONS	5
IV.	REGULATORY COMPLIANCE AND INDEPENDENT TESTING	5
V.	RECEIVING INSPECTIONS	6
VI.	INSTALLATION	7
VII.	OPERATION	9
VIII.	OPERATOR MAINTENANCE	11
	SANITATION & CLEANING	11
IX.	ELECTRICIAN'S MAINTENANCE	12
	TROUBLESHOOTING GUIDE	13
X.	PARTS ILLUSTRATIONS	14
XI.	PARTS LIST	15
XII.	ELECTRICAL SCHEMATIC	16
XIII.	HEAT ON DEMAND BASE CARE & HANDLING	18
XIV.	SERVICE	20
XV.	EQUIPMENT WARRANTY	20

HEAT ON DEMAND[®]2 ACTIVATOR

I. INTRODUCTION

The Aladdin Heat on Demand[®]2 Activator is designed to provide a quick, clean and efficient heat source for use with the Aladdin Heat on Demand[®] base.

The Activator has been specifically created for use ONLY with Aladdin's Heat on Demand[®] bases. There is no exposed coil, open flame or heated surface. The only heat applied to the top surface of the base is that which is absorbed from internal component base parts.

This Activator contains no operator serviceable parts. Please consult a qualified electrician or the Aladdin Service Department should the equipment require service. Aladdin's toll free service line is 1-800-888-5426.



WARNING

This equipment is to be installed only by a qualified electrician. There are no operator serviceable parts inside this Activator. Operators should never remove the back panel or fuse access panel of this Activator.

II. SAFETY

If you know how to correctly install, operate, clean and service the Heat on Demand[®]2 System, your satisfaction with the system will be increased and safety will be enhanced. In accordance with generally accepted product safety labeling guidelines, the following three signal words are used throughout this manual to alert you to potential hazards and to tell you how to avoid them.

WARNING: The word "Warning" identifies a potentially hazardous situation which, if not avoided, COULD result in death or serious personal injury.

CAUTION : The word "Caution" identifies a potentially hazardous situation which, if not avoided, MAY result in minor or moderate injury. The word "Caution" may also be used to alert against unsafe practices and property damage only accidents.

NOTE! The word "Note" is used to identify installation, operation, or maintenance information which is important but not hazard related.

III. SPECIFICATIONS

A. MODEL NUMBER.....	IHA-99S
B. LENGTH.....	23¾ inches (60.3 cm.)
C. WIDTH.....	16¾ inches (42.5 cm.)
D. HEIGHT.....	13¾ inches (33.7 cm.)
E. VOLTAGE.....	200-240VAC
F. FREQUENCY.....	50/60 HZ
G. PHASE.....	1
H. AMPS.....	14
I. NEMA PLUG.....	L6-20P
J. SHIPPING WEIGHT.....	53 POUNDS (32.2kg)
K. NUMBER OF WIRES.....	3
L. PLUG TYPE.....	HUBBELL®preferred or equivalent TWIST LOCK

IV. REGULATORY COMPLIANCE & INDEPENDENT TESTING

This equipment has been listed by the following organizations:

- Underwriters Laboratories--File Number E67324
- National Sanitation Foundation--Standard Number 4

This equipment has been verified to comply with the following:

- Code of Federal Regulations, Title 47, Section 18, Federal Communications Commission
- Code of Federal Regulations, Title 29, Section 1910.97. Occupational Safety and Health Administration

HEAT ON DEMAND[®]2 ACTIVATOR



WARNING

This equipment generates, uses and can emit radio frequency energy and, if not installed and used in accordance with these instructions, may cause harmful interference to radio communications devices. Changes or modifications to this equipment not expressly approved by the party responsible for compliance could void the user's authority to operate this equipment.

There is no guarantee, however, that interference will not occur in a particular installation. If this equipment is found to cause harmful interference to radio communications, the user is encouraged to correct the interference by one or more of the following means:

- A. Reorient or relocate the receiving antenna.
- B. Increase the separation between the equipment and the receiver.
- C. Connect the equipment into an outlet or on a circuit different from that which the receiver is installed.
- D. Consult your sales representative, Aladdin Service Department or an experienced radio/TV technician.

NOTE! Each user is responsible for adherence to existing local codes regarding the posting of warning notices.

V. RECEIVING & INSPECTING THE EQUIPMENT

Even though this equipment is carefully packaged, care should be taken during unloading so the equipment is not damaged.

Carefully check for any visible signs of damage to the carton. If evidence of damage exists, the carton should be opened immediately and a joint inventory and examination of the contents should be made by you and the delivery driver.

If concealed loss or damage is discovered after you have given the carrier a clear delivery receipt, notify the carrier in writing immediately or within 10 days from the delivery date. If you phone the carrier, you must follow up the call in writing to protect your rights. You can only improve your position as a claimant by promptly reporting such loss or damage. You should also retain all cartons or containers, and include the packing material, until an inspection has been made or waived by the carrier.

Notification of loss or damage does not constitute the filing of a claim. You should file your claim in writing with the carrier immediately!

Carriers will furnish the necessary form upon request. You should also request an inspection. If a claim is filed by phone, always follow up immediately in writing.

VI. INSTALLATION

NOTE! This equipment is to be installed only by a qualified electrician. Installation instructions may be obtained from the Aladdin Technical Services Department toll free at 1-800-888-5426.

A. ELECTRICAL CONNECTION

Refer to the specifications data on page 5, the equipment data plate (located near the main power switch), your local codes and the National Electrical Code to be sure the ACTIVATOR is connected to the proper power source. A protected circuit of the correct voltage and amperage must be available for the connection of the power cord.



WARNING

Each Activator is fitted with a grounded power cord and must be connected to a properly grounded receptacle. Each receptacle must be wired to a dedicated circuit protected by a circuit protection device rated at not more than 20 amps. If the Activator is not grounded, a significant electrical shock hazard will exist.

HEAT ON DEMAND[®]2 ACTIVATOR

The Activator has an ON (I)/off (O) switch on the side of the unit near the point where the main power cord is connected. Read the following sections of the manual regarding setup and operation before turning the Activator on.



WARNING

To prevent electrical shock hazard turn the main power switch to the Off (O) position and disconnect the Activator from the power source whenever performing service or maintenance functions. Always turn the Activator Off (O) and disconnect it from the power supply prior to removing the rear vented access panel. It is necessary to do this to prevent electrical shock while performing service.

B. SETTING UP THE EQUIPMENT

The Activator has been completely checked at the Aladdin factory prior to shipment to you. No adjustments of any sort should be required to place the Activator into service. The Activator should be located in a position convenient to the trayline operator, and within 6 feet of the prescribed electrical outlet. The Activator should not be placed where warm air from other equipment is blowing directly on it. The Activator should be placed on a sturdy table capable of supporting a minimum of 100 pounds safely (more if anything else, such as Heat on Demand bases, are to be placed on the table). You may obtain Model # IHAT95 - "Table for Heat Activator" which has been designed specifically for use with this system.



WARNING

To prevent the possibility of fire, place the Activator at least 6 inches from any combustible material with no obstructions within 6 inches of the rear vented access panel

- C. Be sure the Activator is plugged into the proper outlet as indicated in the specifications on page 5 of this manual (Hubbell brand NEMA configuration L6-20P) or equivalent.
- D. Be sure there is at least 6 inches of clearance between the Activator and any combustible materials such as paper, plastic, or cardboard.
- E. Be sure there is at least 6 inches of clearance between the rear of the Activator (where the vents are) and any object which would restrict air flow.
- F. Turn the activator on by turning the main power switch (located on the left side of the Activator at the rear) to the up or "on" (I) position. When this is done, the red "power" light will glow.

After setting the Activator in place, plugging it into the proper electrical outlet and turning it on, the installer should verify the proper operation of the lights as described in the section immediately following. If the lights do not operate as described below, the installer should call the Aladdin Service Department.

In addition to checking for the proper operation of the lights, the installer should verify that the yellow light blinks on and off for approximately 17 seconds when the operation switch in the base guide is activated with a base. If this does not happen, call the Aladdin Service Department.

Finally, the installer should verify that the Heat on Demand base heats properly. Approximately 75 to 90 seconds after the base has been activated (heated) on the Activator for 17 seconds, the round grey area in the top center of the base should be in the range of 175 to 215 degrees Fahrenheit (79 to 101 degrees Celsius). If this is not the case, notify the Aladdin Service Department.

VII. OPERATION

- A. Be sure the Activator is plugged into the proper outlet.
- B. Be sure there is at least 6 inches of clearance between the Activator and any combustible materials such as paper, plastic, or cardboard.
- C. Be sure there is at least 6 inches of clearance between the rear of the Activator (where the vents are located) and any object which would restrict air flow.
- D. Turn the Activator on by turning the main power switch (located on the left side of the Activator at the rear) to the up or "on" (I) position. When this is done the red "power" light will glow.
 1. Operator must place an unheated Heat on Demand base in the proper location to start the heating cycle. To do this, slide the base into the base guide until the heat activation switch is fully depressed.
 2. When the heater activation switch is depressed, the yellow panel light will blink indicating the Activator is heating.

NOTE! Do not remove or tamper with the base during the heating cycle, (while the yellow light is blinking) otherwise the activator will automatically stop heating.

Do not remove or tamper with the base during the heating cycle, (while the yellow light is blinking) and attempt to reinsert the base into the base guide. This procedure can lead to base damage.

3. At the end of the heating cycle, the yellow panel light will stop blinking and a green light, base ready, will illuminate.

HEAT ON DEMAND[®] 2 ACTIVATOR

NOTE! The green light will stay "ON" (I) as long as the heated base remains in position



CAUTION

Never remove a hot Heat on Demand base and place it back on the Activator before using. Never heat a base more than once in a one hour period. This will result in a double heating of the base, which will cause damage.

4. The sequence of operation for this equipment is designed to activate a base in 17 seconds
5. Always turn the main power switch to the "off" (0) or down position at the end of each meal assembly period.
6. DO'S and DON'TS

ALWAYS (DO'S)	NEVER (DON'TS)
<ol style="list-style-type: none"> 1 Heat <u>only</u> Aladdin HEAT on DEMAND[®] bases 2 When calling Aladdin for service, refer to Model Number IHA-99S or IHA 99SAE and Serial Number shown on the Data Plate, on the left side of the unit. 	<ol style="list-style-type: none"> 1 <u>Never</u> strike Activator surface with sharp objects or heavy weights. 2 <u>Never</u> cover bottom of base during activation with paper, cloth, foil or other material. 3 <u>Never</u> place Activator for operation near other equipment with remote controls. 4 <u>Never</u> attempt to heat any metal objects or bases other than Aladdin Heat on Demand bases. 5 <u>Never</u> heat an Aladdin Heat on Demand base that has been heated within the past hour. 6 <u>Never</u> heat Aladdin Heat on Demand Bases in the microwave oven. 7 <u>Never</u> stack bases after activation. 8 <u>Never</u> Heat a base with a dish in it. 9 <u>Never</u> power up the activator with a base present on the surface. Otherwise the service lamp will glow and the unit must be reset without the base present. 10 <u>Never</u> strike Aladdin Heat on Demand[®] bases against any hard surface to clean. (Use caution when scraping base prior to warewashing.) 11 <u>Never</u> heat an Aladdin Heat on Demand[®] base missing the pressure relief poppet. Any base found without a poppet should be removed from service.

VIII. OPERATOR MAINTENANCE



WARNING

Electrical hazard inside, the operator should never open the back panel or fuse access panel of this activator. The back panel should only be opened by a qualified electrician who has read the service and installation manual.

A. SANITATION AND CLEANING PROCEDURES



WARNING

To prevent electrical shock hazard, the main power switch must be in the down or "off (O)" position before cleaning the Activator.

1. Because the top surface remains relatively cool, soil on the top of the Activator will not "cook" onto the top, resulting in a quick and easy cleanup.
2. The Heat on Demand[®] Activator should be cleaned and sanitized after each day's use, or as necessary, by the following method.
 - a. Wipe the top and sides with a clean, damp cloth using warm water and mild dishwashing detergent. (Abrasive pads are not recommended for cleaning)
 - b. Use a soft nylon brush on any food soil and in corner areas.



CAUTION

To prevent damage to the top surface, do not use harsh chemicals or under-diluted sanitizers.



CAUTION

Never use bleach or solutions containing bleach to clean the stainless steel portions of the Heat Activator. The use of this type of product can induce rusting.

- c. Dry thoroughly with a clean dry cloth to remove moisture.
- d. Inspect and clean the air intake filter (see parts illustration page 14) (located on the bottom of the Activator in the front) with warm water and mild detergent once each month, or more frequently if it is heavily soiled. To remove the air intake filter, turn the Activator off and disconnect it from the power source. Turn the Activator on the side and remove the thumbscrew holding the air intake filter in place and lift the filter out. The air intake filter may be immersed in water to clean it. Insure that it is thoroughly dry before placing it back in the Activator.

HEAT ON DEMAND[®]2 ACTIVATOR



WARNING

Do not operate Activator with the air intake filter removed. Foreign particles could enter the Activator and cause an electrical failure. If the Activator is operated without the air filter in place, it is possible for a person to stick their fingers in the moving fan blade and cause personal injury.



WARNING

This Activator is not hose washable. Clean only as directed above. Spraying with a hose can get water in the electrical components and cause a short circuit, or an electrical shock.

B. TROUBLESHOOTING - (See the following page for troubleshooting guide)

IX. ELECTRICIAN MAINTENANCE



WARNING

To prevent electrical shock hazard the vented rear access panel must be opened only by a qualified electrician. Prior to performing any maintenance service, or removing the vented rear access panel, insure the Activator is turned Off (o) and is disconnected from the electrical supply.

NOTE! Fasteners used in the Activator are metric. Any attempt to replace metric fasteners with English fasteners could result in stripped threads or improperly affixed components.

Electrical parts illustrated on the parts illustration, wiring schematic and parts list are for purposes of illustration

only. Only the parts listed on page 15 are replaceable in the field by a qualified electrician. All other servicework will require that the Activator be returned to the Aladdin factory for service. Should the Activator have to be returned for service to the Aladdin factory, contact the Aladdin Service Department to make arrangements for a "loaner" or "maintenance float" Activator.

ELECTRICIAN'S TROUBLESHOOTING GUIDE

No.	MALFUNCTION	CAUSE	SOLUTION
1.	No Power Indicator Light	Main Power switch is off Improper electrical plug connection Power outage Burned out LED	Turn on main power switch Insert and twist plug correctly Check receptacle Call Facilities Maintenance Check LED and replace assembly
2.	Base does not start to heat (No blinking yellow light), but red power light is on.	Incorrectly positioned base	Position base snugly against alignment fixture so that switch is fully depressed
3.	Base does not finish heating (No green light)	Incorrectly positioned base	Remove original base and correctly reposition a new base in alignment fixture. (Do not double cycle the same base) Reset Activator by turning power switch off, waiting 15 seconds, then turning power switch back on. If Activator does not operate properly after resetting, call Aladdin Service Department.
4.	Activator will not run (Red "service" light comes on)	Incorrect voltage Interrupted power Temp too Hot	Check voltage at receptacle. Reset unit: Turn the unit off wait 10 seconds & turn the unit back on. Clean air filter
5.	Activator stops suddenly (power light goes out)	Power cord has become unplugged Power outage Call Facilities Maintenance	Plug back in Do not double cycle base. Reset Activator by turning power switch off, waiting 15 seconds, then turn power switch back on. If Activator does not operate properly after resetting, call Aladdin Service Department.
6.	Top is excessively hot (Over 185 F)	Missing air filter Dirty air filter	Replace air filter immediately. Clean air filter often.
7.	Activator suddenly stops and will not re-start.	Power outage	Call Facilities Maintenance.
8.	Yellow light does not blink for approximately 10 seconds.	Base has been heated within the past hour and is still hot	Use Another Aladdin Heat on Demand base.
9.	Green light comes on immediately after inserting base	Base has been heated within the past hour and is still hot Timer or IFR malfunction	Use a cool (room temp) Aladdin Heat on Demand base. Call Aladdin Service Department.
10.	Low base temperature. (<175°F)		Refer to section VI-B in manual. Calibrate temp probe.

HEAT ON DEMAND[®] 2 ACTIVATOR

X. PARTS ILLUSTRATION

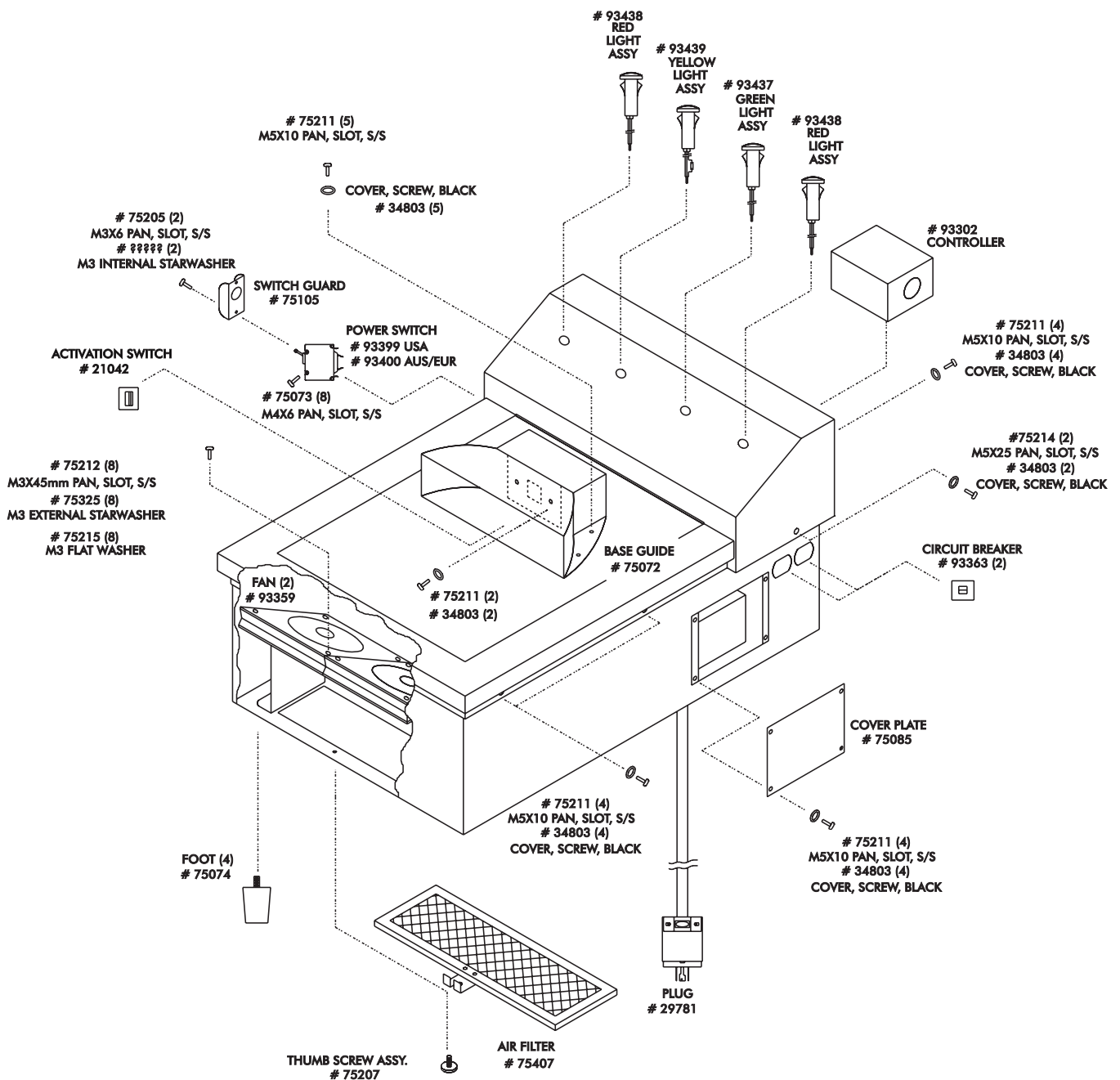

XI. PARTS LIST

Part No.	Description	Qty.	Part No.	Description	Qty.
21042	Switch, Activation	1	92739	Guard, Switch, Power	1
34803	Cover, Bolt Head, Black	19	92771	Assembly, Air Filter	1
93399	Switch, Power, USA	1	75207	Assembly, Thumb screw	1
92734	Panel, Back, Vented	1	93400	Switch, Power, Europe/Australia	1
92601	Assembly, Base Guide IHA-96	1	75205	M 3 x 6, Pan, S/S	2
75074	Foot	4	75211	Bolt, M 5 x 10, Pan, S/S	29
93363	Circuit Breaker, 1 Amp	2	75212	Screw, M 3 x 45, Pan, S/S	8
92738	Plate, Cover, Fuse	1	75214	Bolt, M 5 x 25	2
	Plug, Electrical, 20 Amp 3 wire, Twist lock NEMA L6-20P, USA		75215	Washer, Flat, M 3	8
		1	93444	Nut, Sealing	1
93359	Fan	2	75123	Bushing, Threaded	1
93438	Assembly, Light, Red	2	75112	Label, Warning, Fuse access panel	1
93437	Assembly, Light, Green	1	75158	Label, Caution	1
93439	Assembly, Light, Yellow	1	75121	Label, Warning, Vented Back Panel	1
92578	Sensor IHA96/99S	1	75200	Endcap, Terminal Block	1
93406	Cable, Communication, Controller	1	92598	Housing, Plunger, IHA96	1
93302	Controller HOD	1	92728	Bolt, M5 x 16, Pan, slot, S/S	5
93298	Inverter	1	93413	Coil	1

Electrical parts illustrated on the parts illustration, wiring schematic and parts list are for purposes illustration only. Only the parts listed on page 15 are replaceable in the field by a qualified electrician. All other service work will require that the Activator be returned to the Aladdin factory for service. Should the Activator have to be returned for service to the Aladdin factory, contact the Aladdin Service Department to make arrangements for

a "loaner" or "maintenance float" Activator.

HEAT ON DEMAND[®] 2 ACTIVATOR

XII. ELECTRICAL SCHEMATIC - USA - MODEL IHA-99S

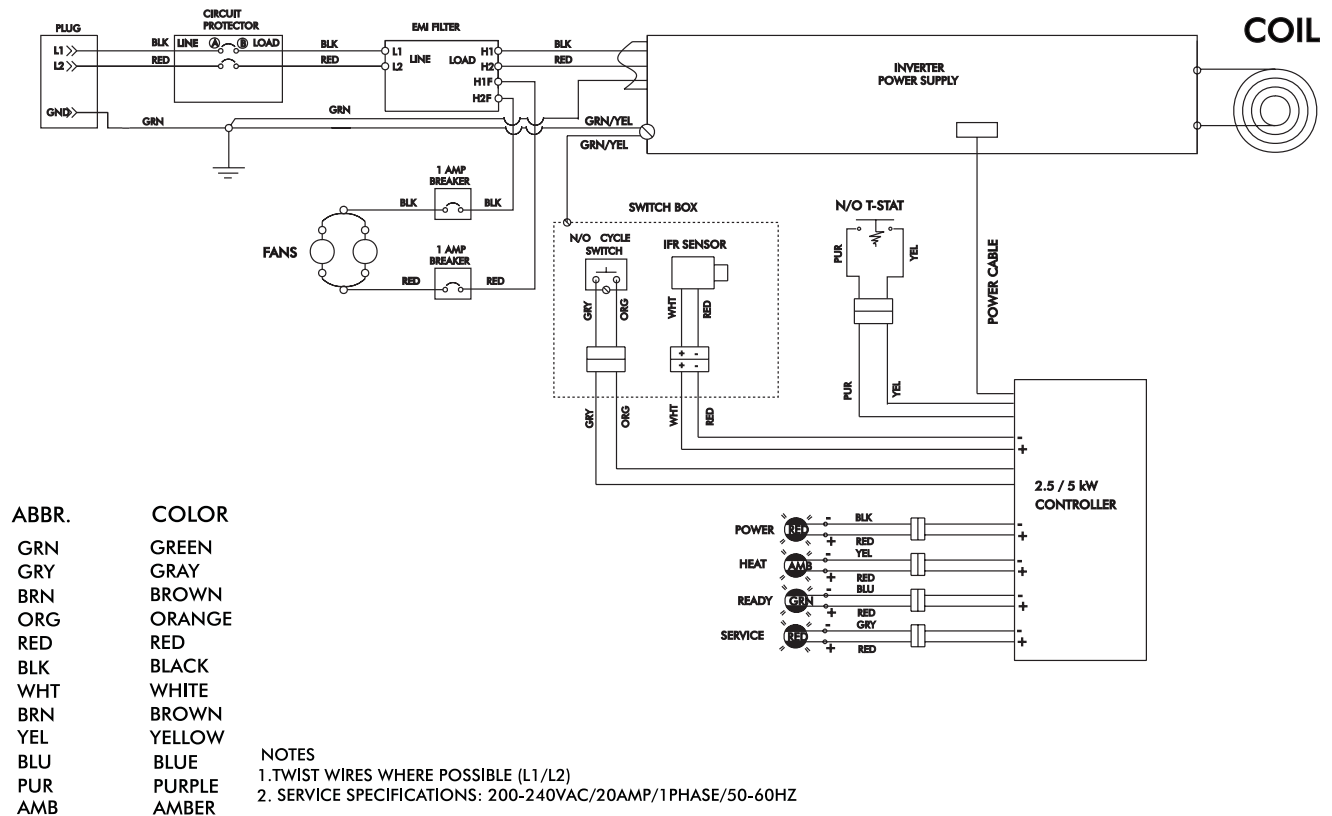

Electrical parts illustrated on the parts illustration, wiring schematic and parts list are for purposes of illustration only. Only the parts listed on page 15 are replaceable in the field by a qualified electrician. All other service work will require that the Activator be returned to the Aladdin factory for service. Should the Activator have to be returned for service to the Aladdin factory, contact the Aladdin Service Department to make arrangements for a "loaner" or "maintenance float" Activator.

ELECTRICAL SCHEMATIC - EXPORT - MODEL IHA-99SAE

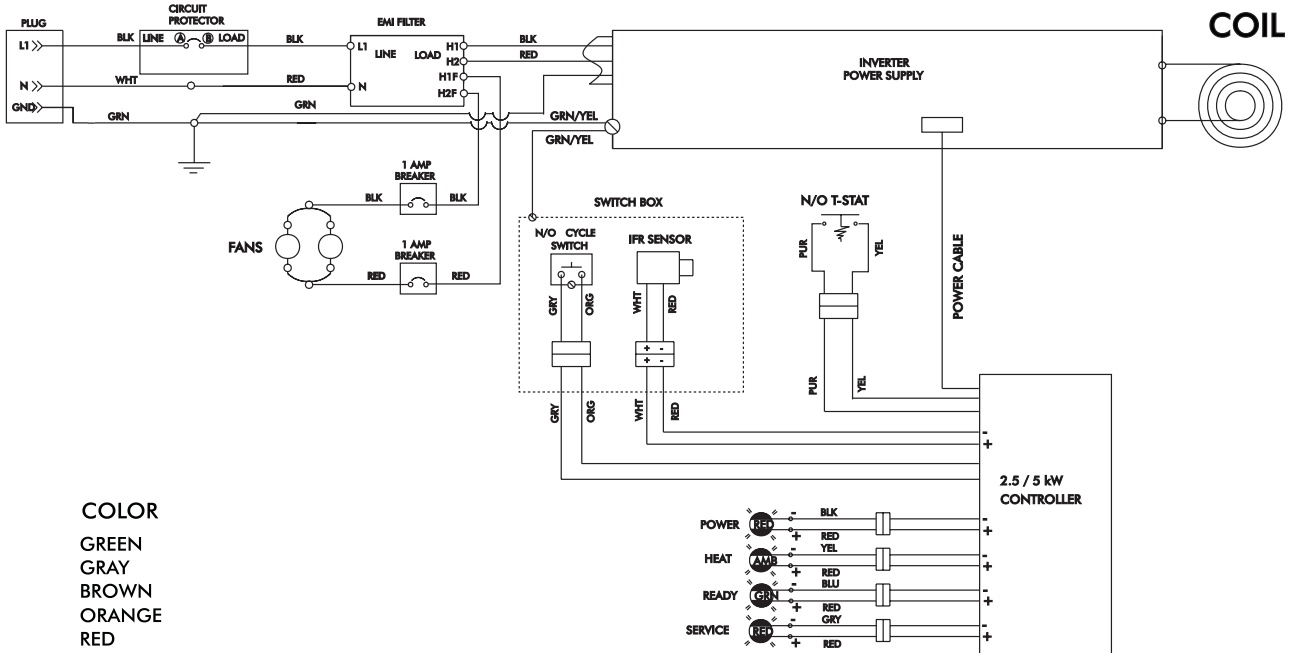

ABBR.	COLOR
GRN	GREEN
GRY	GRAY
BRN	BROWN
ORG	ORANGE
RED	RED
BLK	BLACK
WHT	WHITE
BRN	BROWN
YEL	YELLOW
BLU	BLUE
PUR	PURPLE
AMB	AMBER

- NOTES
1. TWIST WIRES WHERE POSSIBLE (L1/N)
 2. SERVICE SPECIFICATIONS: 200-240VAC/20AMP/1PHASE/50-60HZ

Electrical parts illustrated on the parts illustration, wiring schematic and parts list are for purposes of illustration only. Only the parts listed on page 15 are replaceable in the field by a qualified electrician. All other service work will require that the Activator be returned to the Aladdin factory for service. Should the Activator have to be returned for service to the Aladdin factory, contact the Aladdin Service Department to make arrangements for a "loaner" or "maintenance float" Activator.

HEAT ON DEMAND²® BASES

XIII. BASE CARE & HANDLING INSTRUCTIONS

 **CAUTION**

To prevent damage bases should be activated (HEATED) only by Aladdin Activator. Do not microwave. Do not place in any type of oven or heat source. Do not stack bases after activating.

 **CAUTION**

Aladdin recommends that these bases not be immersed in liquids for longer than 15 minutes.

HEAT-ON-DEMAND® BASE CARE AND HANDLING INTRODUCTION

Certain environmental conditions can affect the life of your bases. Performance and aesthetics are a function of the condition of the bases. These bases are designed to function optimally when used in accordance with these instructions. The following explanations can help you get the longest service from your bases. As with any piece of equipment, the better it is taken care of-the greater the expected usefulness.

A. WAREWASHING

There is a right way to warewash your bases to assure extended usefulness.

Send the bases through the warewashing process at an angle of 60 to 80 degrees.

Avoid inappropriate detergent formulations. Through experience and testing, Aladdin has determined that detergents with very high chlorine levels clean the bases more effectively. The high level of chlorine will not damage the product and will assist in the prevention of stain build-up.

The proper rinse aid will minimize water spotting and will improve the drying process.

Water temperatures in wash and final rinse cycles need to be closely controlled. Wash temperature range should be 150°F minimum, while the final rinse range should be 180°-190°F maximum.

In semiautomatic/automatic rack type dish machines the bases will have to be racked. If an ample number of racks are available, the bases can be allowed to stand for a few minutes in the rack after emerging from the machine. This will allow for better drying.

B. PREMATURE FAILURE

The bases are designed and manufactured to function in an institutional environment. Through experience, we have found certain conditions that may cause premature damage.

Functional as well as cosmetic difficulty will arise from repeated abuse of the bases. The following four precautions listed below will add months to the utility of each base.

1. HIGH DISH MACHINE TEMPERATURE

Dish machine temperatures should not exceed 190°F. Blow dryer temperature should not exceed 200°F. Avoid prolonged exposure to heat inside the dish machine.

2. MISHANDLING

Abuse, such as striking against metal object or dropping on the edge, will shorten the life of the base. Should the base become cracked or broken, it should be removed from service. Continued use could allow the base to absorb water. As a safety feature, this base is equipped with a pressure release valve to prevent pressure build-up should water absorption occur before the base is removed from service.

3. HIGH TEMPERATURE

Avoid direct contact with open flame or high heat sources such as ovens, dish heaters or steam tables. To prevent heat damage to the bases **DO NOT STACK BASES AFTER ACTIVATION.**

4. ABRASIVE CLEANERS

Do not use cleaners which contain abrasives or abrasive pads to clean bases.

C. STAINING OF THE BASES CAN BE CAUSED BY ANY OF THE FOLLOWING:

HARD WATER WHICH HAS A HIGH CONCENTRATION OF CALCIUM AND MAGNESIUM SALTS-
Detergent suppliers can test for water hardness and make recommendations for appropriate detergents and rinse agents and/or water softener.

LOW DISH MACHINE TEMPERATURE

LOW CONCENTRATION OF DETERGENTS

POOR WASHING/RINSING ACTIONS- (i.e., clogged spray jets, low water pressure, final rinse activator not tripped). Proper dish machine maintenance will eliminate most potential problems.

INADEQUATE SPACING BETWEEN BASES IN THE DISH MACHINE

SLIDING OVER A METAL SURFACE MAY LEAVE A STREAK ON THE PLASTIC

D. PERIODIC MAINTENANCE

Bases are equipped with a pressure relief poppet on the bottom. In the unlikely event that water has entered the base, the poppet allows any water to escape. During the periodic inspection of the bases, verify the poppet is present. **If the poppet is missing or damaged, the base should be removed from service.**

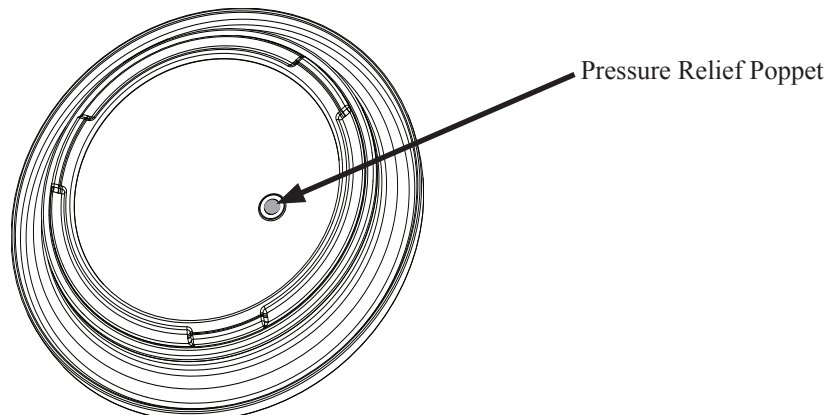

Generally, the care and handling procedures previously outlined will prevent any further action. Yet sometimes persistent problems call for additional care. The bases are generally stain resistant but there are some points to remember. The contact surfaces get very heavy wear and stain exposure. If staining occurs, it is recommended that a special cleaning be performed. Commercial destaining formulas are available. Please contact your detergent supplier.

XIV. SERVICE

In the event service is required on your Aladdin HEAT-ON-DEMAND[®]2 Activator please call:

ALADDIN TEMP-RITE
SERVICE DEPARTMENT
1-800-888-5426

XV. WARRANTY

ALADDIN TEMP-RITE[®]
EQUIPMENT
LIMITED WARRANTY
Effective July 1, 1999

Aladdin Temp-Rite LLC ("ATR") warrants to the original purchaser that the equipment listed below shall be free from defects in material and workmanship under normal use for the applicable warranty term set forth below. ATR's obligation under this warranty is limited to the repair or replacement, at the sole option of ATR, of any part which upon inspection and examination by ATR or its authorized agent is found to be defective. A written description detailing the nature of the claimed defect, together with the equipment claimed to be defective if required by ATR, must be delivered to ATR or its authorized agent within 30 days of discovery of the claimed defect (but in no event later than 30 days after the expiration of the applicable warranty term).

HEAT ON DEMAND [®] EQUIPMENT	WARRANTY TERMS*	
	PARTS	LABOR
HEAT ACTIVATORS (IHA-99S / IHA-99SAE)	1 YEAR	90 DAYS
BASES (IHB98M, IHB98G, IHB98E, IHB98T, IHB98B)	2 YEARS	N/A

*The warranty term commences 30 days after ATR's invoice for the equipment.

THE WARRANTIES AND REPRESENTATIONS OF ATR CONTAINED HEREIN ARE EXPRESSLY IN LIEU OF, AND THE BUYER WAIVES, ANY AND ALL OTHER WARRANTIES EXPRESS OR IMPLIED, INCLUDING THE WARRANTIES OF MERCHANTABILITY AND FITNESS FOR A PARTICULAR PURPOSE, AND ANY OTHER REMEDIES AGAINST ATR, WHETHER BASED UPON CONTRACT, NEGLIGENCE, STRICT LIABILITY OR OTHERWISE. ATR SHALL NOT BE LIABLE FOR ANY CONSEQUENTIAL OR INCIDENTAL DAMAGES OR ECONOMIC LOSS OF ANY NATURE (INCLUDING WITHOUT LIMITATION LOSS OF REVENUES AND/OR PROFITS) THAT MAY BE CLAIMED TO RESULT FROM ANY NEGLIGENCE OR BREACH OF WARRANTY OR CONTRACT BY ATR.

Exceptions and Exclusions

This warranty is issued only to the original purchaser, and is not transferable and applies only to the products installed within the United States of America, its territories and Canada. During the term of any labor warranty, ATR will pay all pre-approved shipping charges incurred in returning defective equipment to ATR and labor costs incurred in the removal and reinstallation of such equipment. Contact ATR before returning any claimed defective equipment or otherwise performing warranty repairs. ATR assumes no liability for any work or repair performed without its prior approval. After the expiration of any labor warranty, the original purchaser is responsible for all shipping charges incurred in returning defective equipment to ATR and labor for removing and reinstalling such equipment. ATR shall not be responsible for the replacement of expendable items like lamps and fuses or product failure resulting from normal wear and tear, improper installation, misuse, sabotage, abuse, neglect, accident, unauthorized alterations or repair, or other factors beyond the control of ATR. Neither this warranty nor the liability of ATR may be modified or extended by action of any agent, distributor or other person or by custom or practice.

CALL ALADDIN TOLL FREE AT 1-800-888-5426 IF YOU HAVE ANY QUESTIONS ABOUT THIS WARRANTY OR YOUR ATR PRODUCT.